



US006034762A

**United States Patent** [19]  
**Cotton et al.**

[11] **Patent Number:** **6,034,762**  
[45] **Date of Patent:** **Mar. 7, 2000**

- [54] **BRAKE CHECK HANDHELD REFRACTOMETER**
- [75] Inventors: **Christopher T. Cotton**, Honeoye Falls;  
**Jeffrey M. Sabin**, Lewiston; **Thomas E. Ryan**, Batavia, all of N.Y.
- [73] Assignee: **Leica Microsystems Inc.**, Buffalo, N.Y.
- [21] Appl. No.: **09/238,547**
- [22] Filed: **Jan. 28, 1999**

3,329,060	7/1967	Holleran .	
3,447,875	6/1969	Goldberg .....	356/135
3,625,620	12/1971	Goldberg .....	356/135
5,355,211	10/1994	Thompson et al. ....	356/135
5,617,201	4/1997	Kahre .....	356/135
5,859,696	1/1999	Nicholas et al. ....	356/128

*Primary Examiner*—Frank G. Font  
*Assistant Examiner*—Roy M. Prunnoose  
*Attorney, Agent, or Firm*—Schwegman, Lundberg, Woessner and Kluth

**Related U.S. Application Data**

- [63] Continuation-in-part of application No. 09/097,368, Jun. 15, 1998.
- [51] **Int. Cl.<sup>7</sup>** ..... **G01N 21/41**
- [52] **U.S. Cl.** ..... **356/135; 356/136; 356/128**
- [58] **Field of Search** ..... **356/135, 136, 356/128, 132**

[57] **ABSTRACT**

A refractometric apparatus and method for monitoring the percentage of water in hydraulic fluids employ a temperature sensitive device allowing a user to obtain accurate and correct readings of various measured properties. In particular, the temperature sensitive member comprises a prism-wedge-mirror combination in conjunction with a bimetallic strip. The combination ensures the proper angular displacement of a light beam inside the refractometric apparatus and, therefore, the correct reading of a parameter to be measured.

[56] **References Cited**

**U.S. PATENT DOCUMENTS**

3,279,309 10/1966 Goldberg .

**41 Claims, 42 Drawing Sheets**

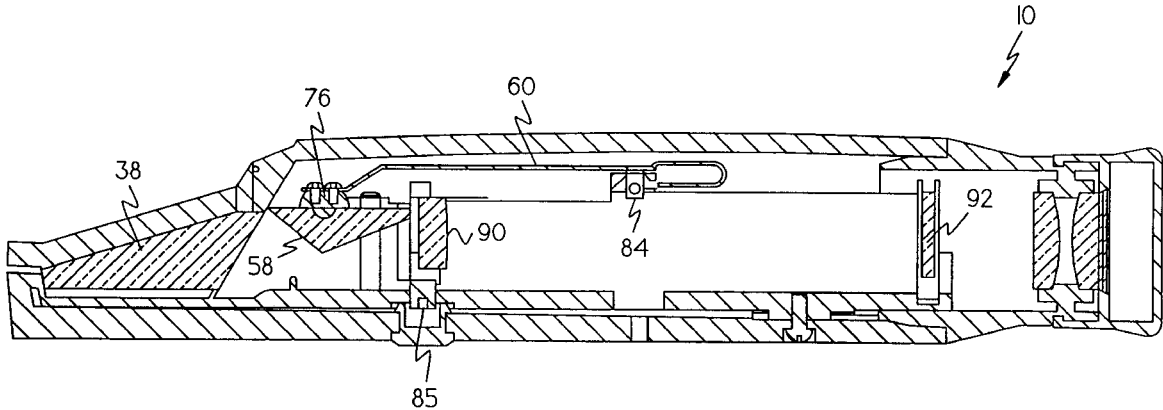

FLUID BRAND	% H2O	KF 1.0	KF 2.0	KF %AD	COR % ADD.	AV. KF	nD-TC		AR600 CORR FROM 24-26 C	nD-TC		AR600 20 C	TC 0.0004	nD-TC *IND TC DOT4	nD-TC AR600 20 C	MARKII 20 C	DIFF. AR600/MARKII 0.0001
							AR600 20 C	0.00035 DOT4		AR600 20 C	TC						
CASTROL DOT4	0	0.2	0.2	0.2	0.2%	0.2%	1.4449	1.4447	1.4448	0.0004	1.4449	1.4448	1.4448	0.0001	1.4448	1.4448	0.0000
	1%	1.3	1.2	1.2	1.2%	1.2%	1.4445	1.4441	1.4440	0.0004	1.4445	1.4440	1.4440	0.0004	1.4440	1.4440	0.0004
	2%	2.1	2.1	2.2	2.2%	2.2%	1.4437	1.4436	1.4439	0.0004	1.4437	1.4439	1.4439	-0.0002	1.4439	1.4439	0.0001
	3%	3.0	3.1	3.3	3.3%	3.3%	1.4431	1.4428	1.4429	0.0004	1.4431	1.4429	1.4429	0.0001	1.4429	1.4429	0.0001
	4%	4.0	4.0	4.3	4.3%	4.3%	1.4423	1.4422	1.4422	0.0004	1.4422	1.4422	1.4422	0.0001	1.4422	1.4422	0.0001
	5%	5.0	4.9	5.4	5.3%	5.3%	1.4414	1.4414	1.4418	0.0004	1.4414	1.4414	1.4418	-0.0004	1.4418	1.4418	0.0000
	6%	5.8	5.8	6.4	6.3%	6.3%	1.4407	1.4406	1.4406	0.0004	1.4407	1.4406	1.4406	0.0000	1.4406	1.4406	0.0000
PRESTONE DOT4	0	0.2	0.2	0.2	0.2%	0.2%	1.4449	1.4445	1.4448	0.0005	1.4449	1.4449	1.4449	0.0000	1.4449	1.4449	0.0000
	1%	1.3	1.3	1.3	1.2%	1.2%	1.4444	1.4439	1.4442	0.0005	1.4444	1.4443	1.4443	0.0001	1.4443	1.4443	0.0001
	2%	2.2	2.2	2.3	2.3%	2.3%	1.4437	1.4435	1.4435	0.0004	1.4437	1.4435	1.4435	0.0002	1.4435	1.4435	0.0002
	3%	3.1	3.1	3.3	3.3%	3.3%	1.4429	1.4429	1.4424	0.0004	1.4429	1.4424	1.4424	0.0005	1.4424	1.4424	0.0005
	4%	4.2	3.9	4.3	4.3%	4.3%	1.4422	1.4421	1.4420	0.0004	1.4422	1.4422	1.4420	0.0002	1.4420	1.4420	0.0002
	5%	4.9	4.8	5.3	5.3%	5.3%	1.4415	1.4413	1.4413	0.0004	1.4416	1.4414	1.4414	0.0002	1.4414	1.4414	0.0002
	6%	6.0	5.7	6.3	6.3%	6.3%	1.4408	1.4405	1.4408	0.0004	1.4408	1.4408	1.4408	-0.0001	1.4408	1.4408	0.0001
STP DOT4	0	0.2	0.2	0.2	0.2%	0.2%	1.4400	1.4399	1.4399	0.0004	1.4400	1.4400	1.4400	0.0001	1.4400	1.4400	0.0001
	1%	1.2	1.1	1.3	1.3%	1.3%	1.4451	1.4448	1.4452	0.0004	1.4451	1.4452	1.4452	-0.0002	1.4452	1.4452	0.0002
	2%	2.3	2.2	2.4	2.3%	2.3%	1.4446	1.4443	1.4444	0.0004	1.4446	1.4444	1.4444	0.0002	1.4444	1.4444	0.0002
	3%	3.2	3.3	3.4	3.4%	3.4%	1.4438	1.4436	1.4436	0.0004	1.4439	1.4436	1.4436	0.0003	1.4436	1.4436	0.0003
	4%	4.3	4.2	4.5	4.5%	4.5%	1.4431	1.4429	1.4429	0.0004	1.4431	1.4429	1.4429	0.0002	1.4429	1.4429	0.0002
	5%	5.0	5.0	5.6	5.6%	5.6%	1.4423	1.4420	1.4422	0.0004	1.4423	1.4422	1.4422	0.0001	1.4422	1.4422	0.0001
	6%	6.0	6.3	6.7	6.6%	6.6%	1.4415	1.4413	1.4412	0.0004	1.4415	1.4412	1.4412	0.0003	1.4412	1.4412	0.0003
7%	6.9	7.0	7.7	7.6%	7.6%	1.4407	1.4406	1.4410	0.0004	1.4407	1.4407	1.4410	-0.0004	1.4410	1.4410	0.0004	
							1.4400	1.4399	1.4397	0.0004	1.4400	1.4398	1.4398	0.0002	1.4398	1.4398	0.0002

FIG. 1A

CASTROL DOT4	0	0.2	0.2	0.2	0.2%	1.4449	1.4449	1.4450	0.0004	1.4449	1.4450	-0.0001
	1%	1.1	1.1	1.3	1.3%	1.4447	1.4444	1.4447	0.0004	1.4447	1.4447	0.0000
	2%	2.0	2.0	2.3	2.3%	1.4440	1.4439	1.4438	0.0004	1.4440	1.4438	0.0002
	3%	3.1	3.0	3.3	3.3%	1.4433	1.4431	1.4434	0.0004	1.4433	1.4434	-0.0001
	4%	3.9	3.9	4.4	4.4%	1.4425	1.4420	1.4426	0.0004	1.4425	1.4426	-0.0001
	5%	5.0	5.0	5.6	5.6%	1.4416	1.4413	1.4414	0.0004	1.4416	1.4414	0.0002
	6%	6.0	5.9	6.6	6.6%	1.4408	1.4407	1.4408	0.0004	1.4408	1.4408	0.0000
	7%	6.5	6.9	7.7	7.6%	1.4401	1.4400	1.4400	0.0004	1.4401	1.4400	0.0000
PRESTONE DOT4	0	0.2	0.2	0.2	0.2%	1.4449	1.4447	1.4449	0.0004	1.4449	1.4449	-0.0001
	1%	1.2	1.2	1.2	1.2%	1.4444	1.4441	1.4443	0.0004	1.4445	1.4444	0.0001
	2%	2.3	2.2	2.3	2.3%	1.4437	1.4435	1.4435	0.0004	1.4437	1.4435	0.0002
	3%	3.2	3.2	3.4	3.3%	1.4428	1.4428	1.4427	0.0003	1.4428	1.4427	0.0001
	4%	4.2	4.2	4.4	4.4%	1.4420	1.4421	1.4421	0.0003	1.4420	1.4421	-0.0001
	5%	5.2	5.0	5.5	5.5%	1.4413	1.4413	1.4415	0.0003	1.4412	1.4415	-0.0002
	6%	6.1	5.8	6.6	6.5%	1.4407	1.4405	1.4405	0.0004	1.4407	1.4405	0.0002
	7%	6.7	6.7	7.7	7.6%	1.4400	1.4396	1.4399	0.0005	1.4401	1.4400	0.0001
WAGNER DOT4	0	0.7	0.7	0.7	0.7%	1.4456	1.4450	1.4459	0.0005	1.4456	1.4459	-0.0002
	1%	1.5	1.5	1.7	1.7%	1.4451	1.4450	1.4448	0.0004	1.4451	1.4448	0.0003
	2%	2.3	2.3	2.5	2.5%	1.4445	1.4445	1.4446	0.0003	1.4445	1.4446	-0.0001
	3%	3.3	3.3	3.5	3.5%	1.4440	1.4439	1.4438	0.0004	1.4440	1.4438	0.0002
	4%	4.2	4.2	4.6	4.5%	1.4432	1.4431	1.4432	0.0004	1.4432	1.4432	0.0000
	5%	5.2	5.2	5.6	5.5%	1.4425	1.4424	1.4420	0.0004	1.4425	1.4420	0.0004
	6%	6.0	6.0	6.6	6.5%	1.4418	1.4417	1.4416	0.0004	1.4418	1.4416	0.0001
	7%	6.6	6.6	7.6	7.5%	1.4410	1.4409	1.4407	0.0004	1.4410	1.4407	0.0003
ALBANY DOT4	0%	0.4	0.4	0.4	0.4%	1.4452	1.4451	-	0.0004	1.4452	-	-
	1%	1.4	1.4	1.4	1.4%	1.4446	1.4445	-	0.0004	1.4446	-	-
	2%	2.4	2.4	2.4	2.4%	1.4440	1.4434	-	0.0005	1.4440	-	-
	3%	3.2	3.4	3.4	3.4%	1.4433	1.4431	-	0.0004	1.4433	-	-
	4%	4.2	4.3	4.5	4.4%	1.4425	1.4424	-	0.0004	1.4425	-	-

FIG. 1B

5%	5.1	5.2	5.5	5.4%	5.1%	1.4418	1.4416	-	0.0004	1.4418	-	0.0002
6%	5.9	6.1	6.5	6.5%	6.0%	1.4410	1.4409	-	0.0004	1.4410	-	0.0000
7%	6.9	7.0	7.6	7.5%	6.9%	1.4403	1.4402	-	0.0004	1.4403	-	0.0000
<b>DOT3</b>												
0	0.4	0.4	0.4	0.4%	0.4%	1.4454	1.4453	1.4452	0.0004	1.4454	1.4452	0.0002
1%	1.3	1.3	1.4	1.4%	1.3%	1.4447	1.4445	1.4447	0.0004	1.4447	1.4448	0.0000
2%	2.2	2.2	2.4	2.4%	2.2%	1.4439	1.4437	1.4439	0.0004	1.4439	1.4440	0.0000
3%	3.2	3.2	3.4	3.4%	3.2%	1.4431	1.4429	1.4427	0.0004	1.4431	1.4428	0.0004
4%	4.2	4.0	4.4	4.4%	4.1%	1.4421	1.4420	1.4426	0.0004	1.4421	1.4426	-0.0005
5%	5.1	4.9	5.4	5.4%	5.0%	1.4414	1.4415	1.4415	0.0003	1.4414	1.4415	-0.0001
6%	6.2	6.0	6.5	6.5%	6.1%	1.4405	1.4406	1.4406	0.0003	1.4405	1.4406	-0.0001
7%	6.9	7.3	7.6	7.5%	7.1%	1.4400	1.4393	1.4393	0.0006	1.4402	1.4395	0.0007
<b>PRESTONE</b>												
0	0.1	0.2	0.2	0.2%	0.2%	1.4453	1.4452	1.4451	0.0004	1.4453	1.4451	0.0002
1%	1.2	1.2	1.2	1.2%	1.2%	1.4447	1.4444	1.4444	0.0004	1.4447	1.4445	0.0002
2%	2.3	2.2	2.2	2.2%	2.2%	1.4440	1.4438	1.4439	0.0004	1.4440	1.4439	0.0001
3%	3.1	3.2	3.3	3.3%	3.1%	1.4432	1.4431	1.4435	0.0004	1.4432	1.4435	-0.0003
4%	4.1	3.8	4.3	4.3%	3.9%	1.4425	1.4423	1.4425	0.0004	1.4426	1.4425	0.0000
5%	5.3	5.1	5.3	5.3%	5.2%	1.4417	1.4415	1.4418	0.0004	1.4417	1.4418	-0.0001
6%	5.8	6.2	6.3	6.3%	6.0%	1.4409	1.4408	1.4408	0.0004	1.4410	1.4408	0.0002
7%	6.3	7.3	7.3	7.3%	6.8%	1.4404	1.4400	1.4401	0.0005	1.4405	1.4402	0.0003
<b>2+2 DOT3</b>												
0	0.3	0.2	0.2	0.2%	0.2%	1.4439	1.4438	1.4440	0.0004	1.4439	1.4440	-0.0001
1%	1.1	1.0	1.1	1.1%	1.1%	1.4433	1.4432	1.4434	0.0004	1.4433	1.4434	-0.0001
2%	1.8	1.7	1.8	1.8%	1.8%	1.4428	1.4426	1.4426	0.0004	1.4428	1.4427	0.0002
3%	2.7	2.8	2.7	2.7%	2.8%	1.4418	1.4418	1.4419	0.0003	1.4418	1.4419	-0.0001
4%	3.6	3.6	3.5	3.5%	3.6%	1.4413	1.4411	1.4409	0.0004	1.4413	1.4409	0.0004
5%	4.7	4.5	4.7	4.7%	4.6%	1.4404	1.4404	1.4403	0.0004	1.4404	1.4403	0.0001
6%	6.4	6.3	6.9	6.8%	6.4%	1.4391	1.4391	1.4391	0.0003	1.4391	1.4390	0.0000
7%	7.3	7.6	8.0	7.9%	7.5%	1.4382	1.4382	1.4385	0.0004	1.4382	1.4385	-0.0002
<b>PRESTONE</b>												
0	0.4	0.3	0.3	0.3%	0.3%	1.4454	1.4453	1.4454	0.0004	1.4454	1.4454	0.0000

FIG. 1C

DOT3	1% 1.2	1.1	1.5	1.4447	1.4447	1.4447	1.4448	0.0003	1.4446	1.4447	-0.0001
	2% 2.2	2.3	2.5	1.4439	1.4439	1.4439	1.4436	0.0004	1.4439	1.4437	0.0002
	3% 2.6	2.7	3.6	1.4437	1.4435	1.4436	1.4436	0.0004	1.4437	1.4437	0.0000
	4% 5.0	5.1	5.5	1.4419	1.4417	1.4415	1.4415	0.0004	1.4419	1.4416	0.0004
	5% 5.3	5.2	6.0	1.4414	1.4414	1.4415	1.4415	0.0003	1.4414	1.4415	-0.0001
	6% 8.2	7.6	8.2	1.4398	1.4398	1.4396	1.4396	0.0004	1.4398	1.4396	0.0002
STP DOT3	0 0.1	-	0.1	1.4461	1.4459	1.4456	1.4456	0.0004	1.4461	1.4457	0.0005
	1% 1.3	-	1.4	1.4450	1.4450	1.4450	1.4450	0.0004	1.4450	1.4450	0.0000
	2% 2.6	-	2.7	1.4441	1.4441	1.4442	1.4442	0.0004	1.4441	1.4442	-0.0001
	4% 4.2	-	4.6	1.4428	1.4427	1.4429	1.4429	0.0004	1.4428	1.4429	-0.0001
	6% 6.9	-	7.2	1.4408	1.4408	1.4408	1.4408	0.0003	1.4408	1.4408	0.0001
	7% 8.1	-	8.5	1.4398	1.4398	1.4397	1.4397	0.0004	1.4398	1.4397	0.0001
STP DOT3	0 0.2	0.2	0.2	1.4459	1.4458	1.4454	1.4454	0.0004	1.4460	1.4455	0.0005
	1% 1.2	1.2	1.2	1.4452	1.4449	1.4451	1.4451	0.0004	1.4452	1.4451	0.0001
	2% 2.2	2.2	2.2	1.4445	1.4442	1.4444	1.4444	0.0004	1.4445	1.4445	0.0000
	3% 3.1	3.2	3.3	1.4437	1.4434	1.4438	1.4438	0.0004	1.4437	1.4438	-0.0001
	4% 4.0	4.1	4.4	1.4429	1.4427	1.4428	1.4428	0.0004	1.4429	1.4429	0.0001
	5% 5.0	4.9	5.4	1.4422	1.4420	1.4421	1.4421	0.0004	1.4422	1.4422	0.0001
	6% 6.0	6.1	6.5	1.4414	1.4413	1.4414	1.4414	0.0004	1.4414	1.4415	-0.0001
COASTAL	0 0.1	0.2	0.2	1.4460	1.4458	1.4456	1.4456	0.0004	1.4460	1.4456	0.0005
DOT3	1% 1.2	1.2	1.2	1.4453	1.4451	1.4452	1.4452	0.0004	1.4453	1.4452	0.0001
	2% 2.1	2.2	2.2	1.4446	1.4443	1.4445	1.4445	0.0004	1.4446	1.4445	0.0001
	3% 3.2	3.2	3.2	1.4438	1.4436	1.4436	1.4436	0.0004	1.4438	1.4436	0.0001
	4% 4.0	4.1	4.3	1.4431	1.4428	1.4431	1.4431	0.0004	1.4431	1.4431	-0.0001
	5% 5.1	5.2	5.4	1.4422	1.4420	1.4420	1.4420	0.0004	1.4422	1.4420	0.0002
	6% 6.1	6.1	6.4	1.4415	1.4413	1.4411	1.4411	0.0004	1.4415	1.4411	0.0004
	7% 7.1	7.3	7.7	1.4406	1.4403	1.4404	1.4404	0.0004	1.4406	1.4405	0.0001
ALBANY	0 0.2	0.2	0.2	1.4440	1.4437	1.4439	1.4439	0.0004	1.4440	1.4439	0.0001
DOT3	1% 1.1	1.1	1.2	1.4433	1.4431	1.4433	1.4433	0.0004	1.4433	1.4433	0.0000

FIG. 1D

2%	2.0	2.1	2.3	2.2%	2.1%	1.4426	1.4424	1.4427	0.0004	1.4426	1.4427	-0.0001
3%	2.9	3.1	3.3	3.2%	3.0%	1.4419	1.4417	1.4417	0.0004	1.4419	1.4417	0.0002
4%	4.0	3.9	4.3	4.2%	4.0%	1.4412	1.4409	1.4412	0.0004	1.4412	1.4412	0.0000
5%	5.1	5.1	5.4	5.3%	5.1%	1.4404	1.4402	1.4401	0.0004	1.4404	1.4401	0.0003
6%	6.0	6.0	6.4	6.3%	6.0%	1.4396	1.4395	1.4397	0.0004	1.4396	1.4397	-0.0001
0	0.3	0.3	0.3	0.3%	0.3%	1.4429	1.4429	1.4430	0.0003	1.4429	1.4430	-0.0001
1%	1.2	1.2	1.3	1.3%	1.2%	1.4422	1.4421	1.4414	0.0004	1.4422	1.4414	0.0008
2%	2.1	2.1	2.4	2.4%	2.1%	1.4414	1.4414	1.4414	0.0003	1.4414	1.4414	0.0000
3%	3.1	3.1	3.4	3.4%	3.1%	1.4406	1.4407	1.4406	0.0003	1.4406	1.4406	0.0000
4%	4.0	4.0	4.5	4.4%	4.0%	1.4400	1.4400	1.4394	0.0004	1.4400	1.4394	0.0006
5%	5.1	5.1	5.6	5.6%	5.1%	1.4391	1.4392	1.4389	0.0003	1.4391	1.4389	0.0002
6%	6.0	6.0	6.6	6.5%	6.0%	1.4385	1.4383	1.4381	0.0004	1.4385	1.4382	0.0004
7%	7.1	7.1	7.7	7.6%	7.1%	1.4377	1.4377	1.4374	0.0004	1.4377	1.4374	0.0003
	0.2	-	-		0.2	1.4449	-	1.4449	0.0004	-	1.4449	
	0.5	-	-		0.5	1.4448	-	1.4448	0.0004	-	1.4448	
	1.0	-	-		1.0	1.4445	-	1.4445	0.0004	-	1.4445	
	1.6	-	-		1.6	1.4441	-	1.4441	0.0004	-	1.4441	
	2.0	-	-		2.0	1.4438	-	1.4438	0.0004	-	1.4438	
	2.4	-	-		2.4	1.4435	-	1.4435	0.0004	-	1.4435	
	3.0	-	-		3.0	1.4428	-	1.4428	0.0004	-	1.4428	
	3.4	-	-		3.4	1.4426	-	1.4426	0.0004	-	1.4426	
	3.9	-	-		3.9	1.4423	-	1.4423	0.0004	-	1.4423	
	4.4	-	-		4.4	1.4420	-	1.4420	0.0004	-	1.4420	
	5.1	-	-		5.1	1.4416	-	1.4416	0.0004	-	1.4416	
	6.1	-	-		6.1	1.4407	-	1.4407	0.0004	-	1.4408	
	6.7	-	-		6.7	1.4403	-	1.4403	0.0004	-	1.4404	
	0.2	-	-		0.2	1.4446	-	1.4446	0.0004	-	1.4448	
	2.4	-	-		2.4	1.4434	-	1.4434	0.0004	-	1.4436	
	5.3	-	-		5.3	1.4411	-	1.4411	0.0004	-	1.4412	

WAGNER  
DOT3

NAPA DOT3

QUAKER  
DOT4

FIG. 1E

7.9	-	-	7.9	1.4391	-	1.4391	0.0004	-	1.4392
0.4	-	-	0.4	1.4432	-	1.4432	0.0004	-	1.4433
4.2	-	-	4.2	1.4406	-	1.4406	0.0004	-	1.4407
6.1	-	-	6.1	1.4395	-	1.4395	0.0004	-	1.4396
7.9	-	-	7.9	1.4381	-	1.4381	0.0004	-	1.4383
1.8	-	-	1.8	1.4423	-	1.4423	0.0004	-	1.4424
0.3	-	-	0.3	1.4448	-	1.4448	0.0004	-	1.4450
2.3	-	-	2.3	1.4436	-	1.4436	0.0004	-	1.4438
4.3	-	-	4.3	1.4422	-	1.4422	0.0004	-	1.4424
6.6	-	-	6.6	1.4406	-	1.4406	0.0004	-	1.4408
0.4	-	-	0.4	1.4442	-	1.4442	0.0004	-	1.4444
1.9	-	-	1.9	1.4429	-	1.4429	0.0004	-	1.4431
4.2	-	-	4.2	1.4414	-	1.4414	0.0004	-	1.4416
7.3	-	-	7.3	1.4392	-	1.4392	0.0004	-	1.4393
0.6	-	-	0.6	1.4445	-	1.4445	0.0004	-	1.4447
3.4	-	-	3.4	1.4428	-	1.4428	0.0004	-	1.4430
6.9	-	-	6.9	1.4403	-	1.4403	0.0004	-	1.4405

WAGNER  
DOT3

PRESTONE  
DOT4

UNK DOT3

QUAKER  
DOT4

FIG. 1F

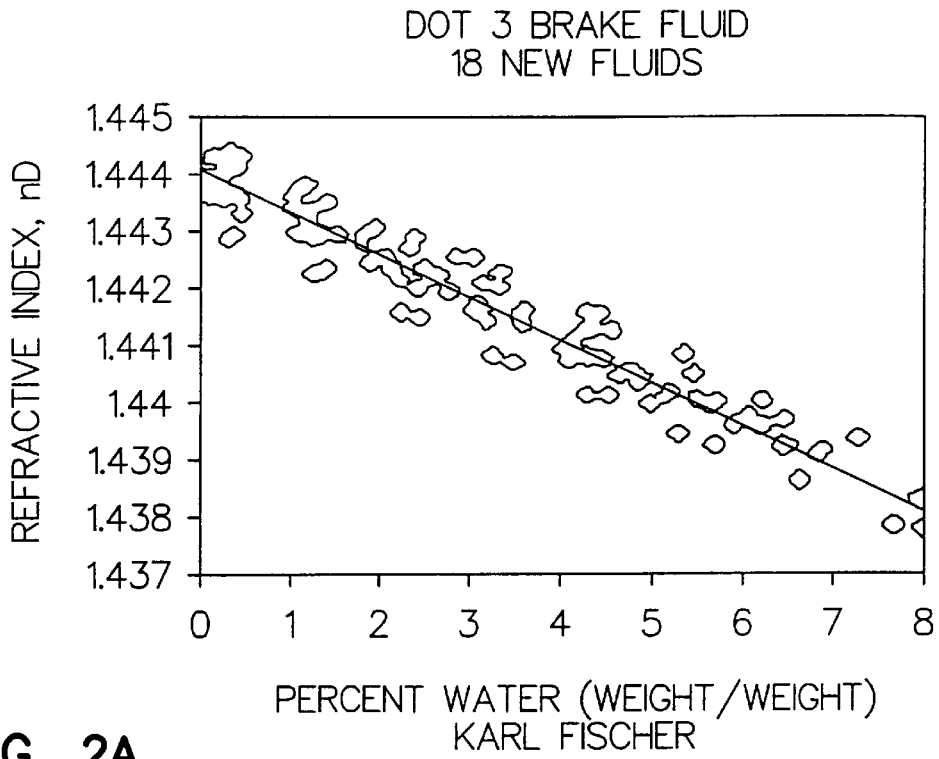

FIG. 2A

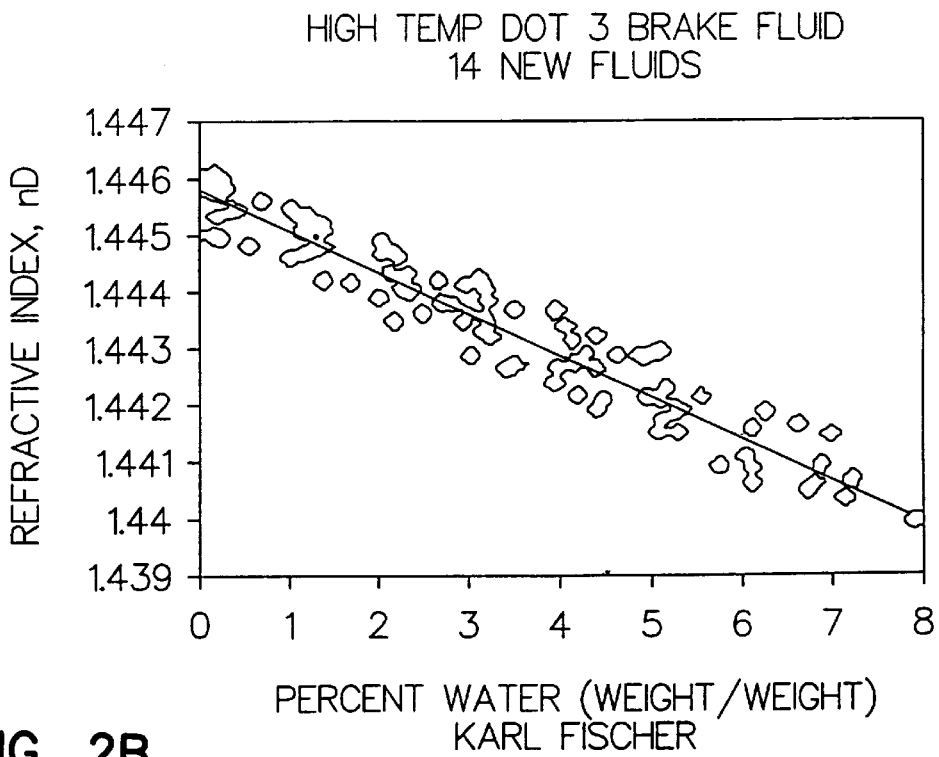

FIG. 2B

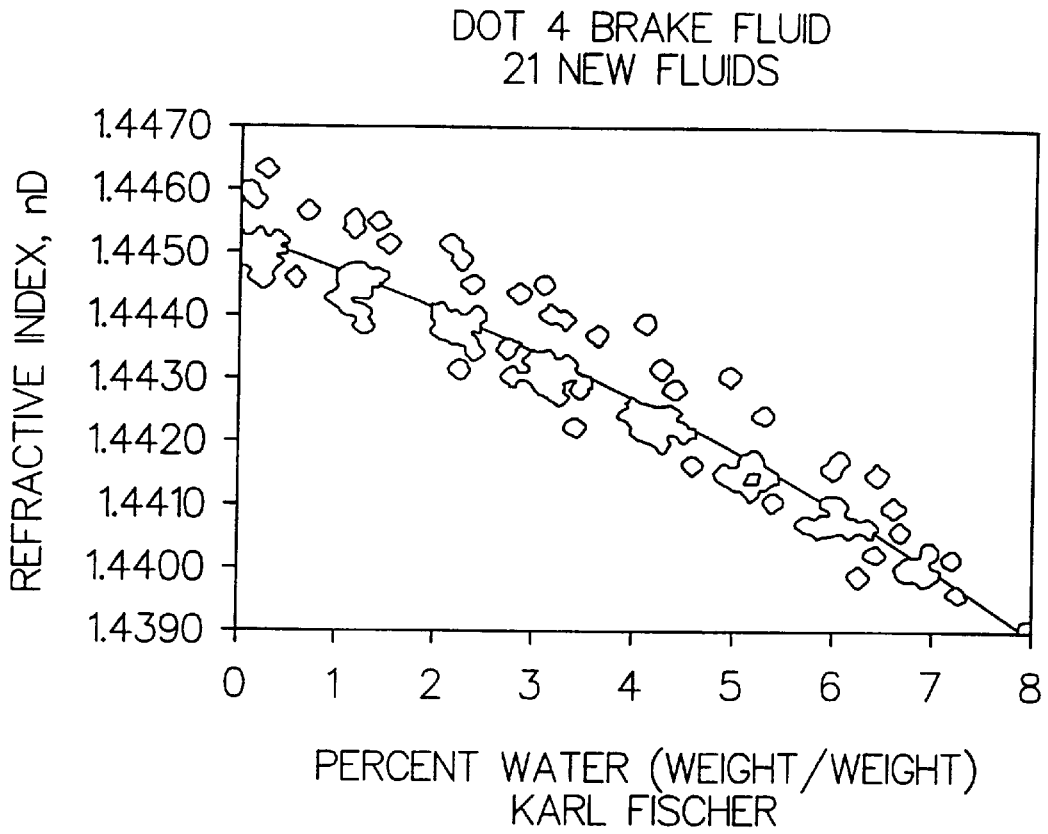

FIG. 2C

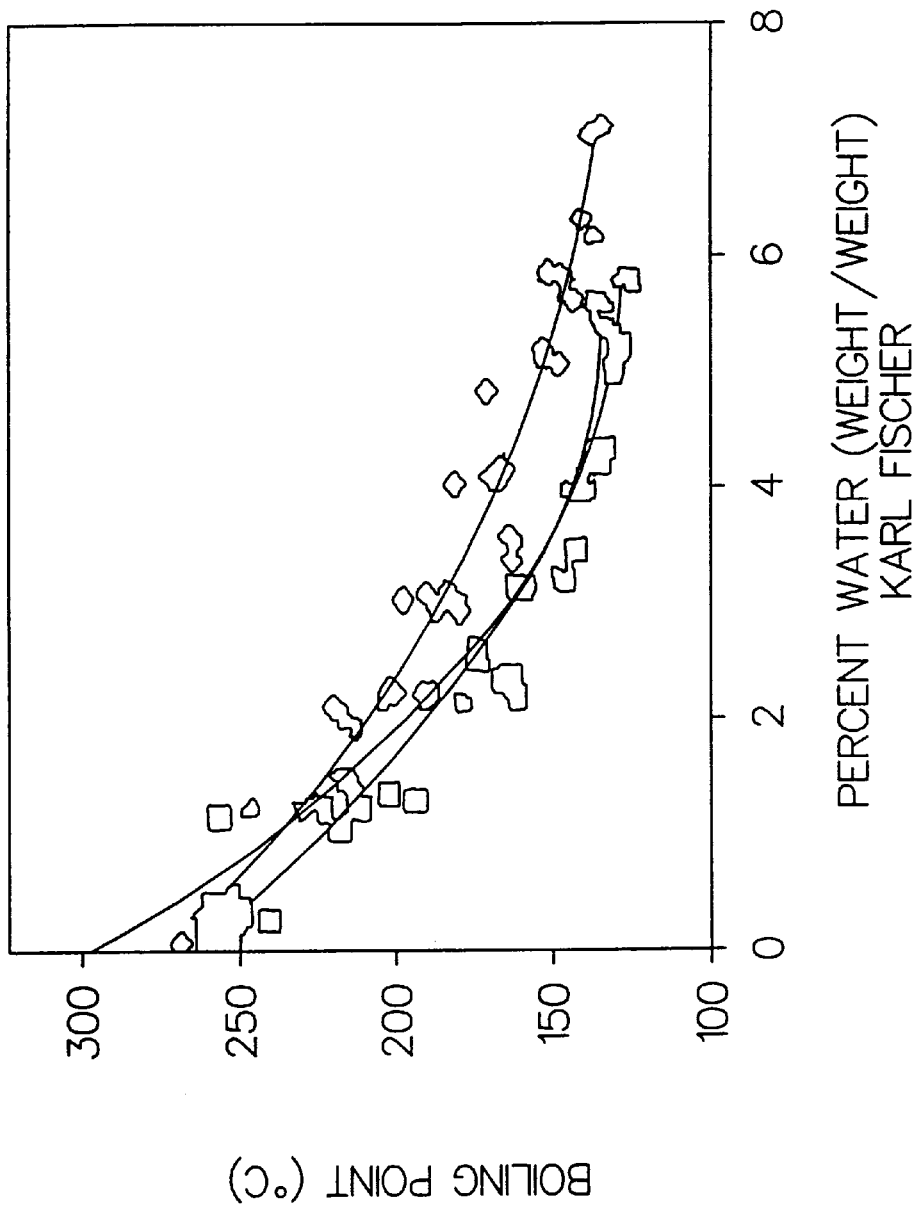

FIG. 3

DOT 3, N=7			
	BOILING POINT	PERCENT H <sub>2</sub> O (WT./WT.)	REFRACTIVE INDEX, nD
FRESH BOILING POINT	252 C.	0.23	1.4435
	+/- 7 C.	+/- 0.14	+/- 0.0004
RANGE	240-262 C.	0.06-0.42	1.4428-1.4440
MIN. DRY BOILING POINT	250 C.	1.15	1.4429
		+/- 0.38	+/- 0.0004
RANGE			
MIN. WET BOILING POINT	140 C.	4.4	1.4406
		+/- 0.3	+/- 0.0004
RANGE			
HIGH TEMP DOT 3, N = 6			
FRESH BOILING POINT	281 C.	0.14	1.4457
	+/- 18 C.	+/- 0.07	+/- 0.0004
RANGE	263-305 C.	0.07-.26	1.4449-1.4460
MIN. DRY BOILING POINT	205 C.	1.56	1.4447
		+/- 0.35	+/- 0.0004
MIN. WET BOILING POINT	140 C.	4.65	1.4425
		+/- 0.39	+/- 0.0004
DOT 4, N = 9			
FRESH BOILING POINT	259 C.	0.18	1.4452
	+/- 18 C.	+/- 0.08	+/- 0.0005
RANGE	248-264 C.	0.06-0.30	1.4448-1.4462
MIN. DRY BOILING POINT	230 C.	1.11	1.4447
		+/- 0.28	+/- 0.0005
MIN. WET BOILING POINT	155 C.	5.1	1.4418
		+/- 0.46	+/- 0.0005

FIG. 4

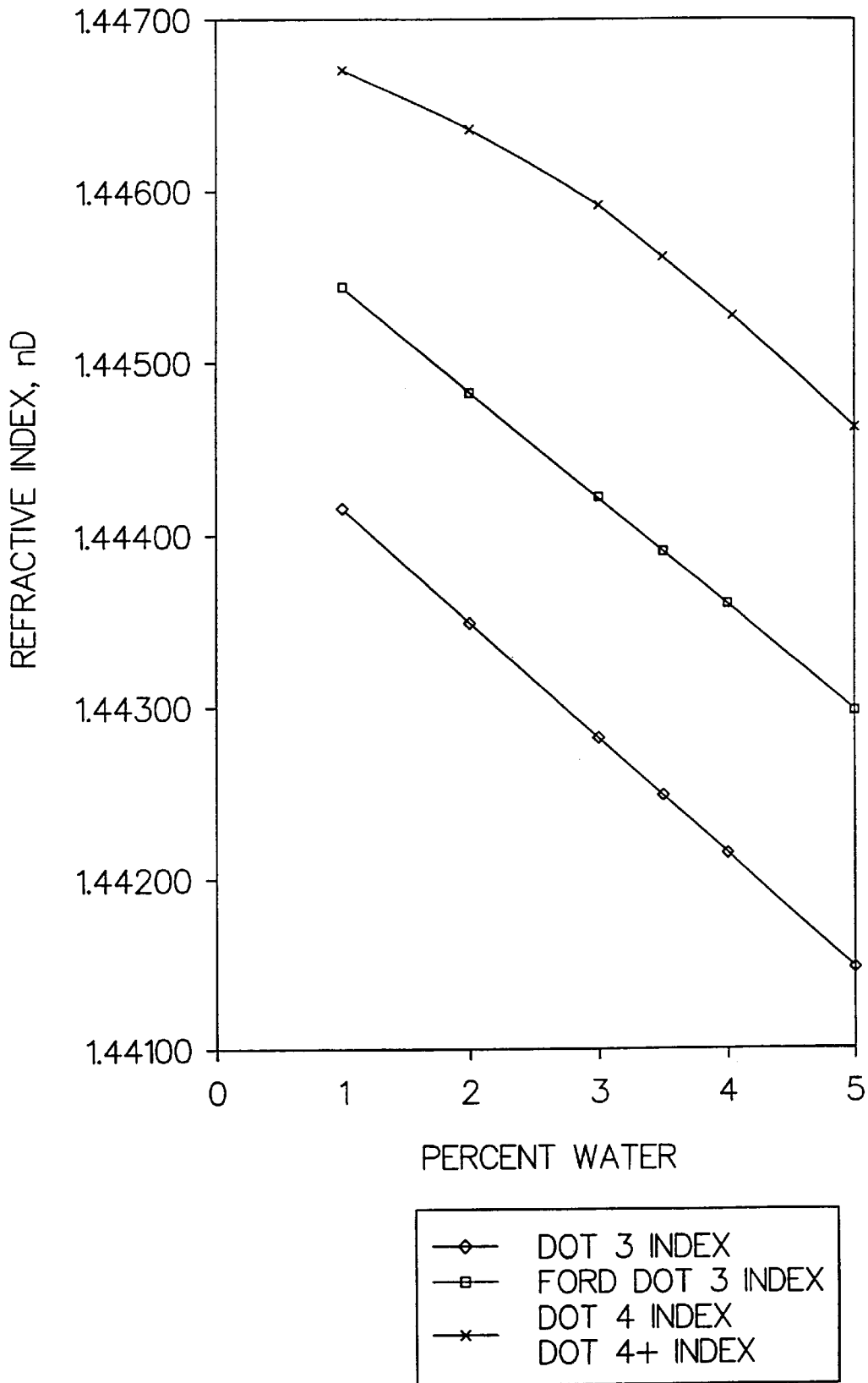

FIG. 5

WATER CONCENTRATION PERCENT (WEIGHT/WEIGHT)	DOT 3 N = 9	DOT 4 N = 7
NEW	-0.00038 +/- 0.00002	-0.00041 +/- 0.00004
2%	-0.00038 +/- 0.00003	-0.00040 +/- 0.00004
4%	-0.00039 +/- 0.00002	-0.00039 +/- 0.00003
6%	-0.00037 +/- 0.00003	-0.00038 +/- 0.00002
USED FLUID, N = 101	-0.00037 +/- 0.000014	

FIG. 6

Date	Model	Year	"In Use" Automotive Samples		Karl Fisher 1.0	Karl Fisher 2	Average Karl Fisher	nD AR600 20 Deg C (+/- 0.5 C)	Temp
			Karl Fisher	Karl Fisher					
8-Jul-97	Chevy Caprice	1986	4.4	4.174	4.289	1.44099	19.34		
	Chevy Cavalier	1988	2.4	2.366	2.368	1.44266	19.88		
	Plymouth Neon	1997	0.3	0.311	0.327	1.44399	20		
	Plymouth Neon	1997	0.3	0.287	0.291	1.44422	20.05		
10-Jul-97	Geo Metro	199X	4.2	4.867	4.538	1.44135	19.51		
	Audi 5000S	1996	2.3	2.711	2.523	1.44379	19.49		
	Pontiac Grand	1987	3.3	3.344	3.340	1.44175	19.93		
	Saturn	1993	2.3	2.403	2.338	1.44214	20.18		
	Hyundia Elantra	1993	3.2	3.225	3.198	1.44312	20.26		
	Geo Spectrum	1989	3.4	3.559	3.497	1.44182	20.16		
	Toyota Camry	1990	4.3	4.298	4.293	1.44179	20.19		
22-Jul-97	Buick Somerset	198X	2.8	2.993	2.919	1.4415	20.26		
	Chevy Cavalier	1985	2.6	2.601	2.607	1.44252	20.12		
	Dodge Shadow	199X	1.4	1.345	1.391	1.44373	20.12		
	Eagle Summit	1990	3.7	3.77	3.745	1.442	19.87		
22-Jul-97	Dodge Shadow	1985	4.6	4.746	4.669	1.44139	19.95		
	Mitsubishi-ABS	1995	1.2	-	1.241	1.4441	19.88		

FIG. 7A

nD		TC = 0.00037		TC		nD-TC		nD-TC		% Differ		C		reflux	
AR600	T	Mark II	Temp	TC	AR600	20 Deg C	20 Deg C	Mark II	20 Deg C	1.x10 <sup>-3</sup>	L	O	hadowlin	boiling	point
(+/- 2 C)		(+/- 0.5 C)			20 Deg C										(+/- 5. C)
1.4388	25.3	1.4405	20.2	0.000371	1.44074	1.4406	1.4406	1.4406	11.77%	3	3		fuzzy	-	
1.4415	25.2	1.4431	20.3	0.00022	1.44262	1.4432	1.4432	1.4432	41.33%	4	4		v. fuzzy	-	
1.442	25.2	1.4435	20.4	0.000388	1.44399	1.4436	1.4436	1.4436	23.62%	1	1		sharp	-	
1.4423	25.1	1.4439	20.9	0.000369	1.44424	1.4442	1.4442	1.4442	0.23%	1	1		sharp	-	
1.4394	25.6	1.4414	20.4	0.000315	1.44117	1.4415	1.4415	1.4415	26.47%	1	1		sharp	-	
1.4415	25.6	1.4438	20	0.000367	1.44360	1.4438	1.4438	1.4438	13.85%	1	1		sharp	-	
1.4396	25.6	1.4418	19.2	0.000382	1.44172	1.4415	1.4415	1.4415	15.40%	3	3		fuzzy	-	
1.4401	25.7	1.442	20.1	0.000375	1.44221	1.4420	1.4420	1.4420	11.78%	3	3		fuzzy	-	
1.4411	25.7	1.4427	20.2	0.00037	1.44322	1.4428	1.4428	1.4428	30.66%	rpl			sharp	-	
1.4392	25.8	1.4419	20.3	0.000465	1.44188	1.4420	1.4420	1.4420	9.16%	1	1		sharp	-	
1.4397	25.8	1.4417	20.3	0.000373	1.44186	1.4418	1.4418	1.4418	3.40%	3	3		fuzzy	-	
1.4394	25.9	1.4416	20.3	0.000373	1.44160	1.4417	1.4417	1.4417	7.97%	2	2		sharp	-	
1.4403	26	1.4428	19.9	0.000368	1.44256	1.4428	1.4428	1.4428	13.73%	ee			fuzzy	-	
1.4415	26	1.4436	20.3	0.000375	1.44377	1.4437	1.4437	1.4437	4.36%	2	2		sharp	-	
1.4395	26	1.4421	20	0.000405	1.44195	1.4421	1.4421	1.4421	10.29%	3	3		sharp	-	
1.4392	26	1.4409	20	0.000365	1.44137	1.4409	1.4409	1.4409	32.71%	5	5		v. fuzzy	-	
1.4421	25.3	1.444	20	0.000377	1.44406	1.4440	1.4440	1.4440	3.83%	1	1		sharp	-	212

FIG. 7B

22-Jul-97	Buick Regal	1988	2.1	-	2.097	1.44303	19.97
	Dodge Suburba	1985	1.2	-	1.165	1.44412	20
	Chrysler Voyag	1992	1.8	-	1.769	1.444	20
ABS	Chev. Truck	1995	1.0	-	0.963	1.44312	20.08
	Chrysler Voyag	1987	4.8	-	4.819	1.44255	20.02
ABS	Chev. Corsica	1996	0.9	-	0.880	1.44322	20.14
23-Jul-97	Chev. Truck	1986	2.3	-	2.294	1.44277	20.42
	Toyota	1989	4.6	-	4.633	1.44134	20.63
	Pontiac Sunbird	1987	3.1	-	3.107	1.44181	20.04
	Dodge Dakota	1987	1.4	-	1.363	1.44458	20.09
ABS	Chev. Truck	1988	2.5	-	2.462	1.44334	19.98
ABS	Honda	19XX	2.0	-	2.012	1.44301	20.18
24-Jul-97	Chev. Cavalier	1997	0.3	-	0.257	1.44322	20.89
	Saturn	1995	1.1	-	1.062	1.44281	20.64
	Chev. Blazer	1995	1.2	-	1.170	1.44256	20.72
	Chev. Truck	1991	2.2	-	2.220	1.44189	20.72
	Honda Accord	1989	2.6	-	2.589	1.44223	20.93
	Plymouth Acclai	1989	4.5	-	4.527	1.44193	20.88
	Chev. Cavalier	1986	4.0	-	3.962	1.44122	20.91
	Olds Cvera	1987	3.5	-	3.487	1.44151	20.81
5-Aug-97	Dodge Van	1983	5.5	-	5.530	1.44087	19.47
	Chevy Blazer	1994	1.2	-	1.200	1.44349	19.3
	Sunbird	1988	3.6	-	3.640	1.44183	19.23

FIG. 7C

1.441	25.4	1.4429	20	0.000366	1.44302	1.4429	8.24%	4	sharp	176
1.4422	25.3	1.4439	20.1	0.000365	1.44412	1.4439	12.66%	2	sharp	214
1.4421	25.3	1.4438	20.1	0.000371	1.44400	1.4438	11.27%	en	fuzzy	178
1.4413	25.1	1.4429	20	0.000373	1.44315	1.4429	17.31%	4	sharp	220
1.4407	25.1	1.4425	20	0.000364	1.44256	1.4425	3.98%	5	v. fuzzy	139
1.4413	25.2	1.443	20	0.000377	1.44327	1.4430	18.86%	3	sharp	225
1.441	25	1.4431	20.3	0.000377	1.44293	1.4432	19.77%	3	sharp	172
1.4398	24.8	1.4415	19.5	0.000375	1.44157	1.4413	18.11%	d(	sharp	140
1.44	24.7	1.4413	20.1	0.00038	1.44182	1.4413	33.83%	2	fuzzy	161
1.4429	24.7	1.4445	20.3	0.000376	1.44461	1.4446	0.12%	3	sharp	221
1.4416	24.7	1.4432	20	0.000376	1.44333	1.4432	9.18%	4	fuzzy	167
1.4413	24.7	1.4432	20.1	0.000378	1.44308	1.4432	11.10%	1	sharp	183
1.4418	24.6	1.4435	19.9	0.000375	1.44355	1.4435	6.15%	1	sharp	243
1.4413	24.7	1.4424	20.3	0.000381	1.44305	1.4425	37.20%	2	sharp	205
1.4409	25.1	1.4428	20	0.000386	1.44283	1.4428	1.96%	2	sharp	214
1.4402	25.2	1.442	20.1	0.000375	1.44216	1.4420	8.39%	3	fuzzy	164
1.4405	25.5	1.4424	20.1	0.000377	1.44258	1.4424	9.65%	2	sharp	171
1.4402	25.5	1.4421	20.3	0.000369	1.44226	1.4422	3.20%	4	sharp	136
1.4395	25.5	1.4414	20.3	0.000376	1.44156	1.4415	3.28%	4	v. fuzzy	142
1.4398	25.5	1.4416	20.3	0.00037	1.44181	1.4417	6.94%	3	sharp	147
1.4393	23.8	1.4407	20.1	0.000359	1.44067	1.4407	4.49%	4	fuzzy	132
1.4418	24	1.443	21.1	0.000357	1.44323	1.4434	12.51%	3	fuzzy	211
1.44	24.3	1.4405	22	0.000367	1.44154	1.4412	20.68%	4	sharp	159

FIG. 7D

	Plymouth	1995	0.9	-	0.870	1.4442	19.53
	Chevy Cavalier	1992	3.1	-	3.100	1.44222	19.59
	Honda	1996	1.7	-	1.718	1.44376	19.23
6-Aug-97	Pontiac Grand Buick	1993	0.9	1.153	0.914	1.44311	19.41
	Chevrolet	1997	0.8	-	0.831	1.44371	19.51
	Chev. Caprice	1997	0.3	-	0.343	1.44391	19.61
	Chev. Celebrity	1986	4.7	-	4.705	1.4411	19.37
	Olds Cutlass Ci	1988	2.0	-	2.033	1.44366	19.54
	Chevy Blazer	1990	3.5	-	3.452	1.44209	19.69
	Pontiac Transp	1987	3.6	-	3.632	1.44097	19.82
	Chev. Cavalier	1995	1.2	-	1.152	1.44305	19.97
11-Aug-97	Plymouth	1994	1.2	-	1.205	1.44288	20.25
	Olds Cutlass	1991	2.0	-	1.994	1.44369	20.08
	Jeep Cherokee	1990	2.3	-	2.320	1.44259	20.16
	Mitsubishi	1996	0.7	-	0.675	1.44386	20.2
	Nissan	1992	3.7	-	3.659	1.44321	20.35
	Honda Accord	1997	1.0	-	1.004	1.44415	20.3
	Buick	1989	4.0	-	4.017	1.44189	20.39
12-Aug-97	Chev. S10 (Jeff	1997	0.3	-	0.250	1.44352	20.35
ABS	Nissan Pathfind	1989	3.5	-	3.486	1.44182	20.06
	Cavalier	1994	2.6	-	2.606	1.44295	20.19
	Saturn	1987	3.0	-	2.972	1.44188	20.24
		1995	1.1	-	1.149	1.44302	20.41

FIG. 7E

1.4422	25	1.4428	23	0.000364	1.44402	1.4439	7.42%	2	sharp	233
1.4402	25	1.441	22.8	0.000367	1.44207	1.4420	1.67%	3	fuzzy	159
1.4417	24.5	1.4435	19.8	<u>0.00039</u>	1.44347	1.4434	3.30%	2	sharp	202
1.4411	24.5	1.4426	20.4	0.000386	1.44289	1.4427	9.78%	4	sharp	214
1.4417	24.6	1.4432	20.5	0.000387	1.44353	1.4434	9.78%	2	sharp	232
1.442	24.6	1.4434	20.5	0.000387	1.44376	1.4436	12.36%	1	sharp	241
1.4391	24.6	1.4406	20.6	0.000376	1.44087	1.4408	2.90%	2	sharp	147
1.4417	24.65	#####	20.4	0.000382	1.44349	1.4431	23.53%	5	fuzzy	171
1.4402	24.8	1.4413	20.4	0.000381	1.44197	1.4414	36.45%	5	v. fuzzy	152
1.4391	24.9	1.4405	20.4	0.000379	1.44090	1.4406	17.62%	5	fuzzy	139
1.4411	25	1.4428	20.7	0.000384	1.44304	1.4431	1.52%	4	sharp	226
1.4412	24.6	1.4429	20.3	0.000379	1.44297	1.4430	2.68%	1	sharp	211
1.442	24.7	1.4437	20.5	0.000372	1.44372	1.4439	11.53%	4	sharp	190
1.4408	24.9	1.4427	20.3	0.000375	1.44265	1.4428	11.24%	3	sharp	170
1.4421	25	1.4437	20	0.000375	1.44393	1.4437	16.24%	2	sharp	245
1.4414	25.3	1.4434	20.3	0.000373	1.44334	1.4435	11.87%	1	sharp	184
1.4423	25.3	1.4439	20.7	0.000377	1.44426	1.4442	6.99%	1	sharp	223
1.4401	25.3	1.4419	20.4	0.000365	1.44204	1.4420	0.95%	4	fuzzy	151
1.4418	24.9	1.4433	19.2	0.000383	1.44365	1.4430	44.94%	1	sharp	247
1.4399	25.1	1.4419	20.5	0.000376	1.44184	1.4421	16.92%	4	fuzzy	155
1.4411	25.2	1.443	20	0.000378	1.44302	1.4430	1.44%	2	sharp	180
1.44	25.3	1.4415	20	0.000375	1.44197	1.4415	32.56%	5	v. fuzzy	144
1.4412	25.3	1.443	20.6	0.000368	1.44317	1.4432	3.52%	1	sharp	209

FIG. 7F

Mitsubishi	1991	3.2	-	3.205	1.44265	20.46
Chev. (Heston)	1985	3.2	-	3.230	1.44182	20.46
Cavalier (Russ-I)	1987	6.0	-	6.030	1.43993	20.2
Chev. (Brian C)	1987	3.0	-	2.990	1.44213	20.17
<b>7-Aug-97 Toyota</b>	1989	5.4	-	5.449	1.44025	19.9
<b>H2O Adde Chevy Cavalier</b>	1992	4.9	-	4.866	1.44038	20.07
Olds Cutlass Ci	1990	6.7	-	6.736	1.43939	20.1
Pontiac Sunbird	1988	5.2	-	5.235	1.43919	20.18
Chev. Caprice	1986	5.4	-	5.369	1.43946	20.13
Chevy Cavalier	1986	6.4	-	6.388	1.43931	20.21
Plymouth Acclai	1989	7.2	-	7.154	1.43936	20.22
Chevy Blazer	1987	7.5	-	7.534	1.43807	20.12
Olds Cvera	1987	7.9	-	7.933	1.4378	20.2
Sunbird	1987	7.9	-	7.910	1.43843	20.24

<b>Ford Samples</b>						
11-Aug-97 Ford Probe	1991	4.4	-	4.414	1.44202	20.35
10-Jul-97 Ford Bronco	1988	2.0	1.987	2.015	1.44331	19.44
Ford Taurus	1985	7.0	7.052	7.021	1.43907	20.05
Ford Taurus	1986	2.9	2.82	2.836	1.44323	20.33
Ford Van	1989	5.1	5.183	5.162	1.44137	20.02
23-Jul-97 Ford Aspire	1995	1.9	-	1.918	1.44259	20.32

FIG. 7G

1.4409	25.3	1.4428	20.6	0.00037	1.44282	1.4430	14.01%	3	fuzzy	169
1.44	25.5	1.4419	20.9	0.000367	1.44199	1.4422	16.91%	5	v. fuzzy	152
1.438	25.5	1.4398	20.8	0.000371	1.44000	1.4401	6.50%	4	fuzzy	131
1.4402	25.5	1.442	20.6	0.00037	1.44219	1.4422	2.09%	5	v. fuzzy	165
1.439	24.2	1.44	20.8	0.00036	1.44021	1.4403	5.92%	-	fuzzy	-
1.439	24.3	1.44	20.8	0.00037	1.44041	1.4404	0.56%	-	fuzzy	-
1.438	24.4	1.439	20.8	0.00037	1.43943	1.4396	11.86%	-	fuzzy	-
1.438	24.4	1.439	20.7	0.00037	1.43926	1.4393	0.26%	-	fuzzy	-
1.438	24.5	1.44	20.7	0.00037	1.43951	1.4399	24.47%	-	sharp	-
1.438	24.5	1.439	20.7	0.00037	1.43939	1.4388	43.61%	-	fuzzy	-
1.438	24.7	1.439	20.3	0.00036	1.43944	1.4395	4.85%	-	v.R14 fuzzy	-
1.436	24.7	1.438	20.8	0.00037	1.43811	1.4382	5.80%	-	fuzzy	-
1.436	24.8	1.438	20.8	0.00036	1.43787	1.4384	36.40%	-	sharp	-
1.437	24.8	1.438	20.9	0.00036	1.43852	1.4387	15.01%	-	fuzzy	-

1.4404	24.6	1.442	20.3	0.000375	1.44215	1.4421	2.67%	1	sharp	148
1.441	25.6	1.4431	20.3	0.000372	1.44310	1.4432	7.65%	2	sharp	-
1.437	25.7	1.4389	20.1	0.000367	1.43909	1.4389	10.52%	4	fuzzy	-
1.4412	26	1.443	20.3	0.000365	1.44335	1.4431	16.71%	4	fuzzy	-
1.4392	26	1.441	20	0.000356	1.44138	1.4410	26.19%	5	fuzzy	-
1.4409	24.9	1.4424	20.1	0.000383	1.44271	1.4424	18.85%	2	sharp	189

FIG. 7H

12-Aug-97	Ford Probe	1994	1.7	-	1.687	1.44333	20.31
Ford Samples- Different							
10-Jul-97	Lincoln Town C	1990	1.3	1.413	1.351	1.44558	19.34
24-Jul-97	Ford Escort	1988	2.7	-	2.743	1.44462	20.88
24-Jul-97	Ford Taurus	1993	1.1	-	1.075	1.44578	21.01
24-Jul-97	Ford Ranger	1991	2.8	-	2.795	1.4452	20.53
23-Jul-97	Ford Subn	1994	2.5	-	2.527	1.44524	20.48
10-Jul-97	Mercury Grand	1987	3.5	3.512	3.504	1.44471	20.03
10-Jul-97	Mercury Sable	1987	1.7	1.588	1.629	1.44512	20.11
22-Jul-97	Ford Taurus	1994	1.2	-	1.150	1.4453	19.78
23-Jul-97	Ford Taurus	1994	1.0	-	1.007	1.44583	20.09
23-Jul-97	Mercury Grand	1990	1.3	-	1.302	1.44476	20.01
6-Aug-97	Ford Explorer	1996	0.8	-	0.842	1.44588	19.87
11-Aug-97	Ford Escort	1990	1.9	-	1.905	1.44439	20.31
	Ford Crown Vic.	1989	3.1	-	3.062	1.44475	20.3
8-Aug-97	Ford Explorer	1996	5.1	-	5.096	1.44273	20
H2O Adde	Ford Taurus	1993	5.4	-	5.437	1.44287	20.17
	Ford Subn	1994	5.7	-	5.740	1.44277	20.18
	Ford Escort	1988	6.4	-	6.416	1.44207	20.21
	Mercury Marqui	1990	6.6	-	6.573	1.44104	20.32

FIG. 71

1.4415	25.3	1.4434	20.5	0.000374	1.44345	1.4436	9.75%	1	sharp	194
1.4432	25.6	1.4453	20.1	0.000376	1.44533	1.4453	0.22%	ee	sharp	-
1.4429	25.4	1.4449	20.2	0.000388	1.44495	1.4450	1.84%	en	fuzzy	169
1.4441	25.4	1.4457	20.3	0.000381	1.44616	1.4458	23.83%	3	sharp	250
1.444	23.8	1.444	19.8	0.000384	1.44540	1.4439	#####	5	fuzzy	179
1.444	23.8	1.4448	19.5	0.000384	1.44542	1.4446	55.73%	4	fuzzy	199
1.4424	26	1.4448	20.2	0.000383	1.44472	1.4449	10.61%	5	very fuzzy	-
1.443	25.7	1.4455	19.8	0.000377	1.44516	1.4454	18.30%	4	fuzzy	-
1.4432	25.4	1.4451	20	0.000379	1.44522	1.4451	8.17%	5	sharp	232
1.4442	24.2	1.4455	20	0.00039	1.44586	1.4455	25.15%	4	sharp	294
1.4429	24.9	1.4448	20	0.000382	1.44476	1.4448	2.51%	3	fuzzy	1
1.4439	24.9	1.4457	20.5	0.000388	1.44583	1.4459	3.78%	3	sharp	259
1.4425	25.3	1.4445	20.6	0.000376	1.44450	1.4447	15.05%	4	fuzzy	189
1.4428	25.4	1.4449	20.2	0.000381	1.44486	1.4450	7.82%	5	very fuzzy	155
1.441	25.1	1.443	20.5	0.00037	1.44273	1.4427	3.03%	-	sharp	-
1.441	25	1.443	20.7	0.00036	1.44293	1.4431	8.83%	-	sharp	-
1.441	25	1.443	20.8	0.00036	1.44284	1.4434	38.87%	-	very fuzzy	-
1.44	25.1	1.443	20.3	0.00035	1.44215	1.4427	39.06%	-	fuzzy	-
1.439	25.1	1.441	20.4	0.00036	1.44116	1.4415	27.04%	-	sharp	-

FIG. 7J

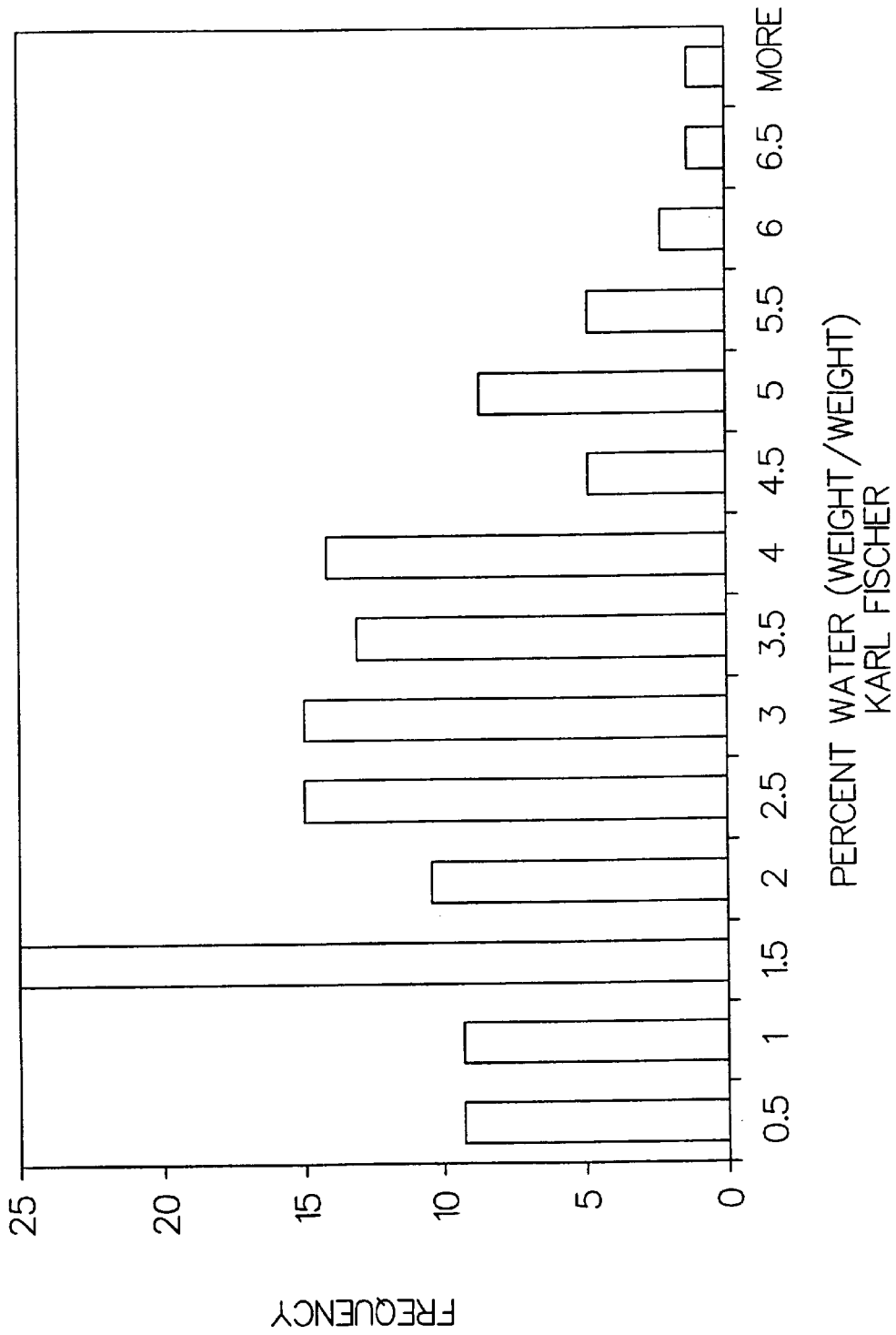

FIG. 8

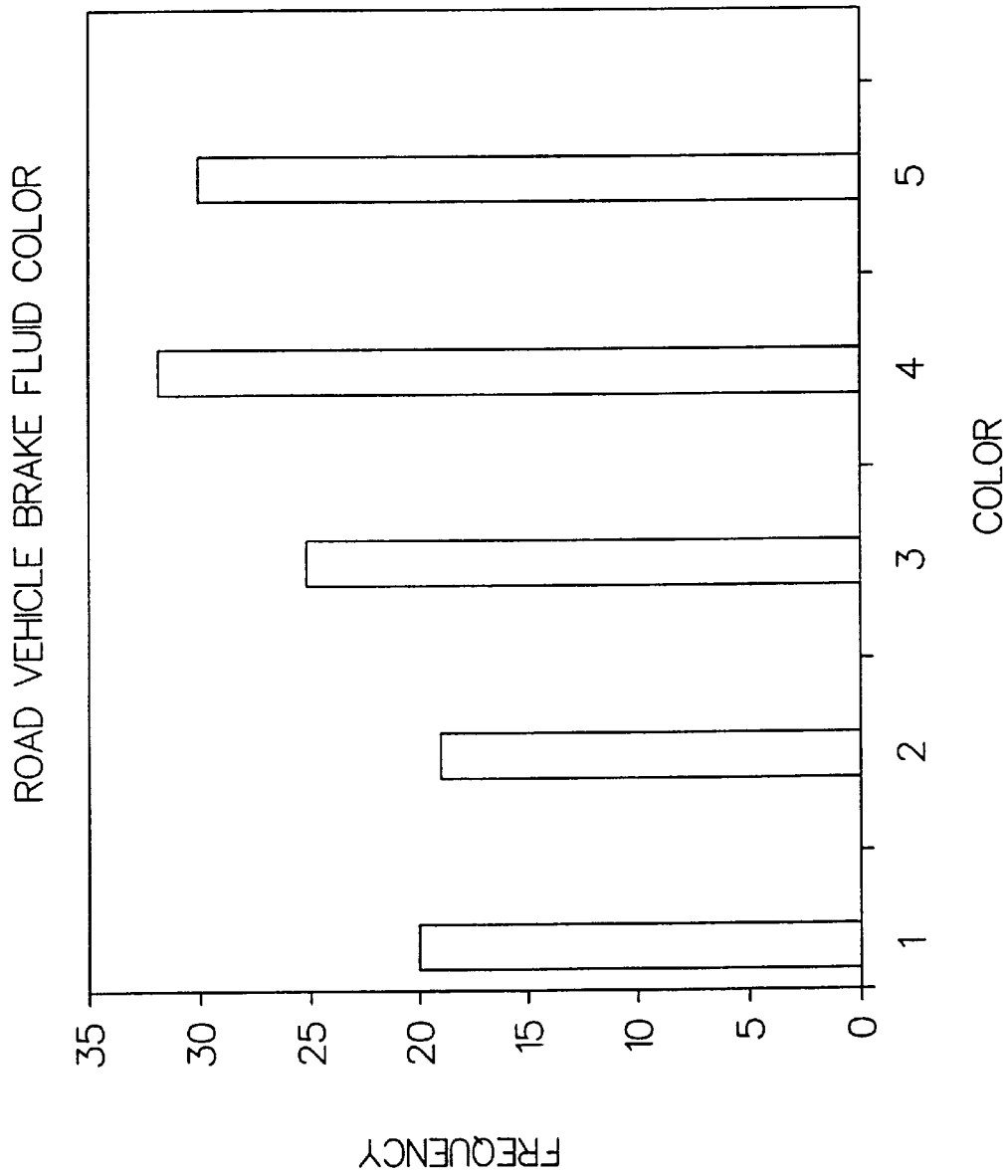

FIG. 9

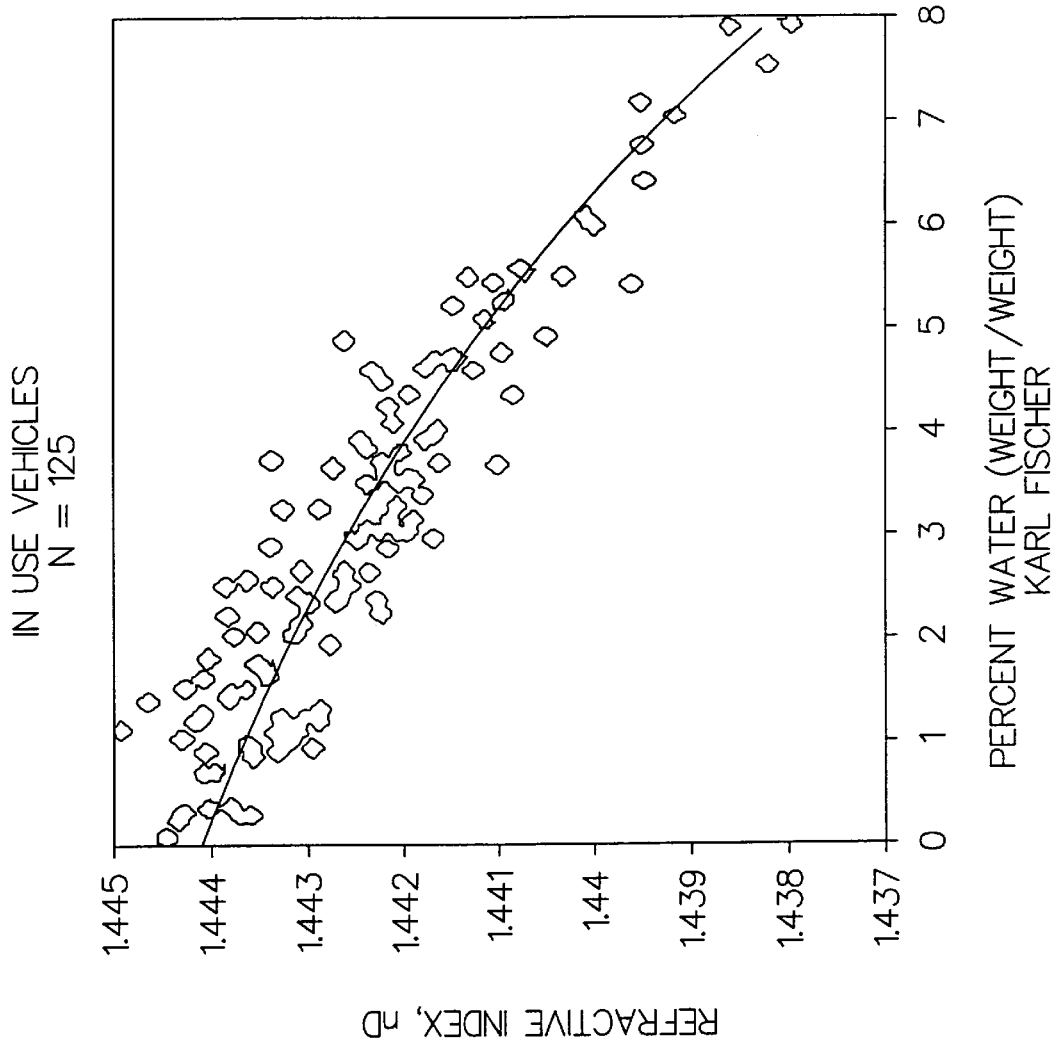

FIG. 10

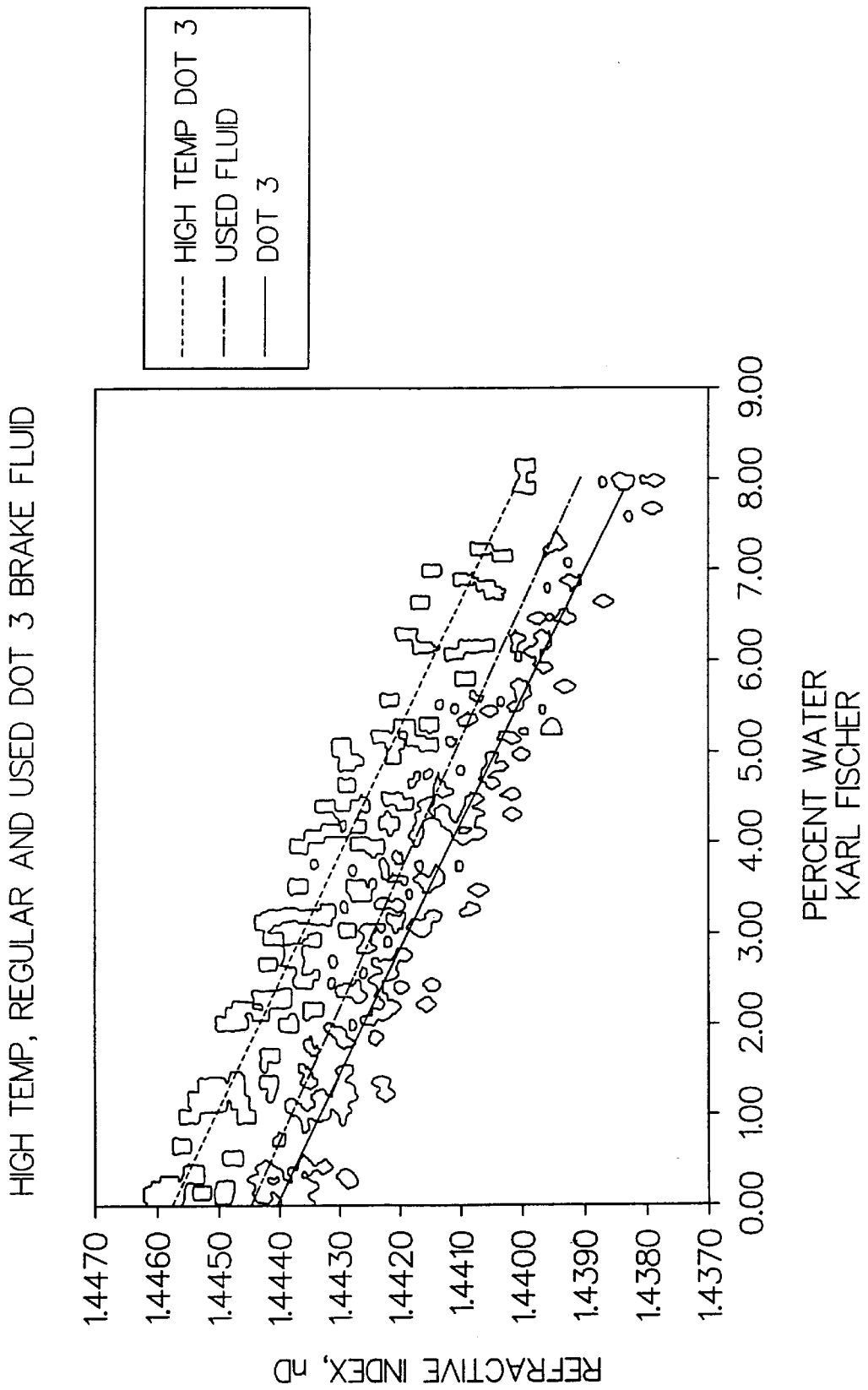

FIG. 11

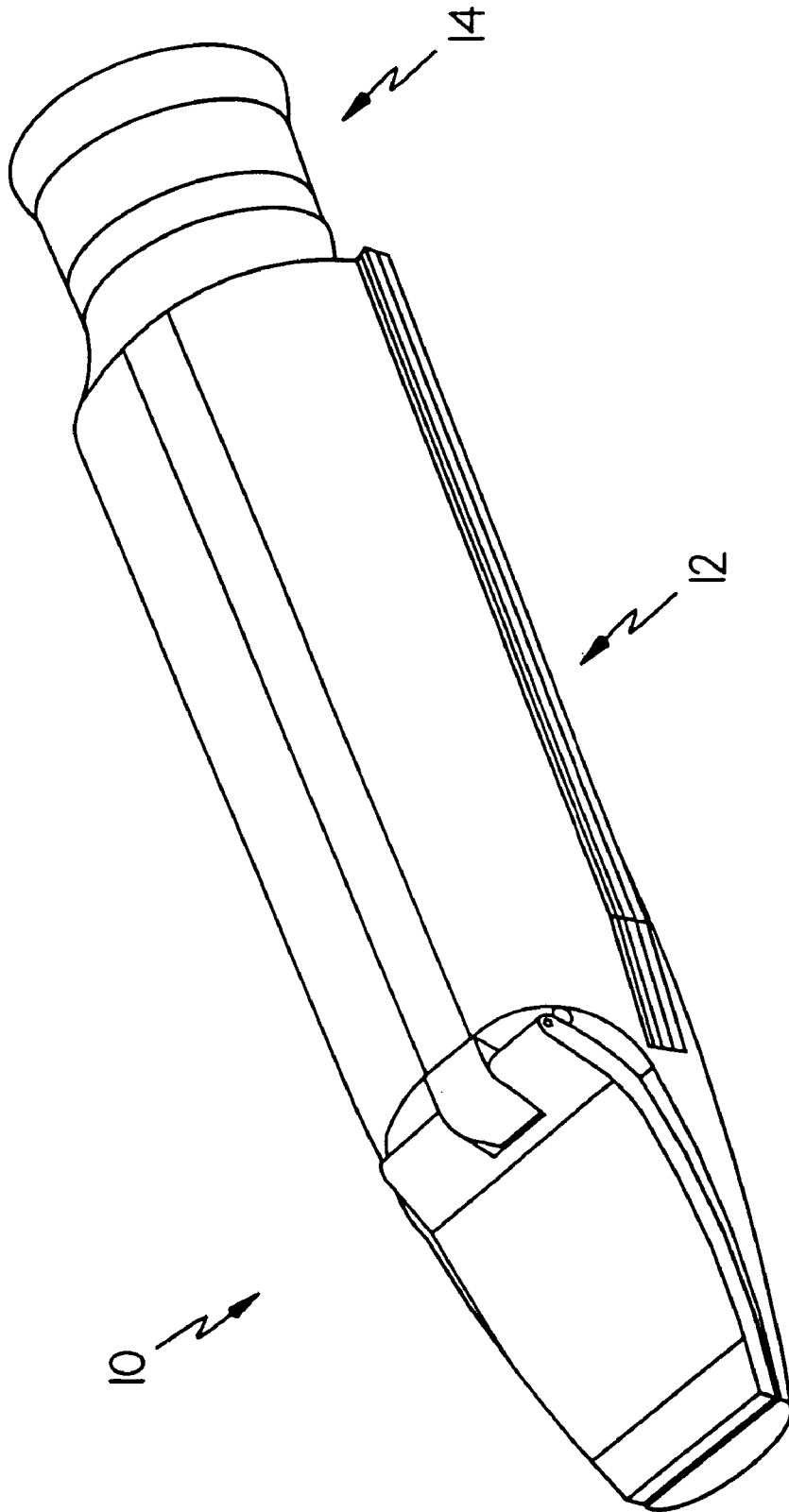

FIG. 12

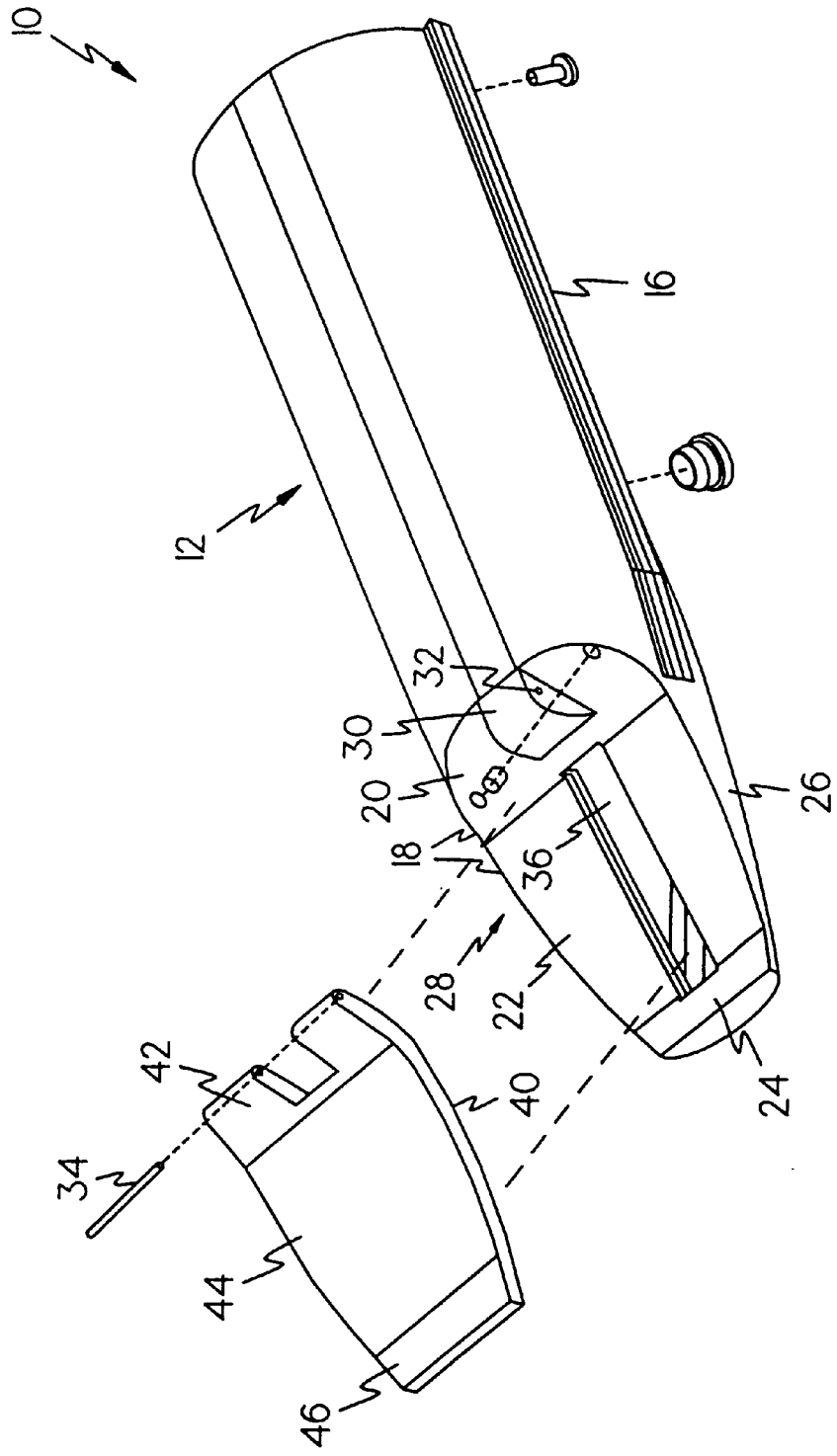

FIG. 13A

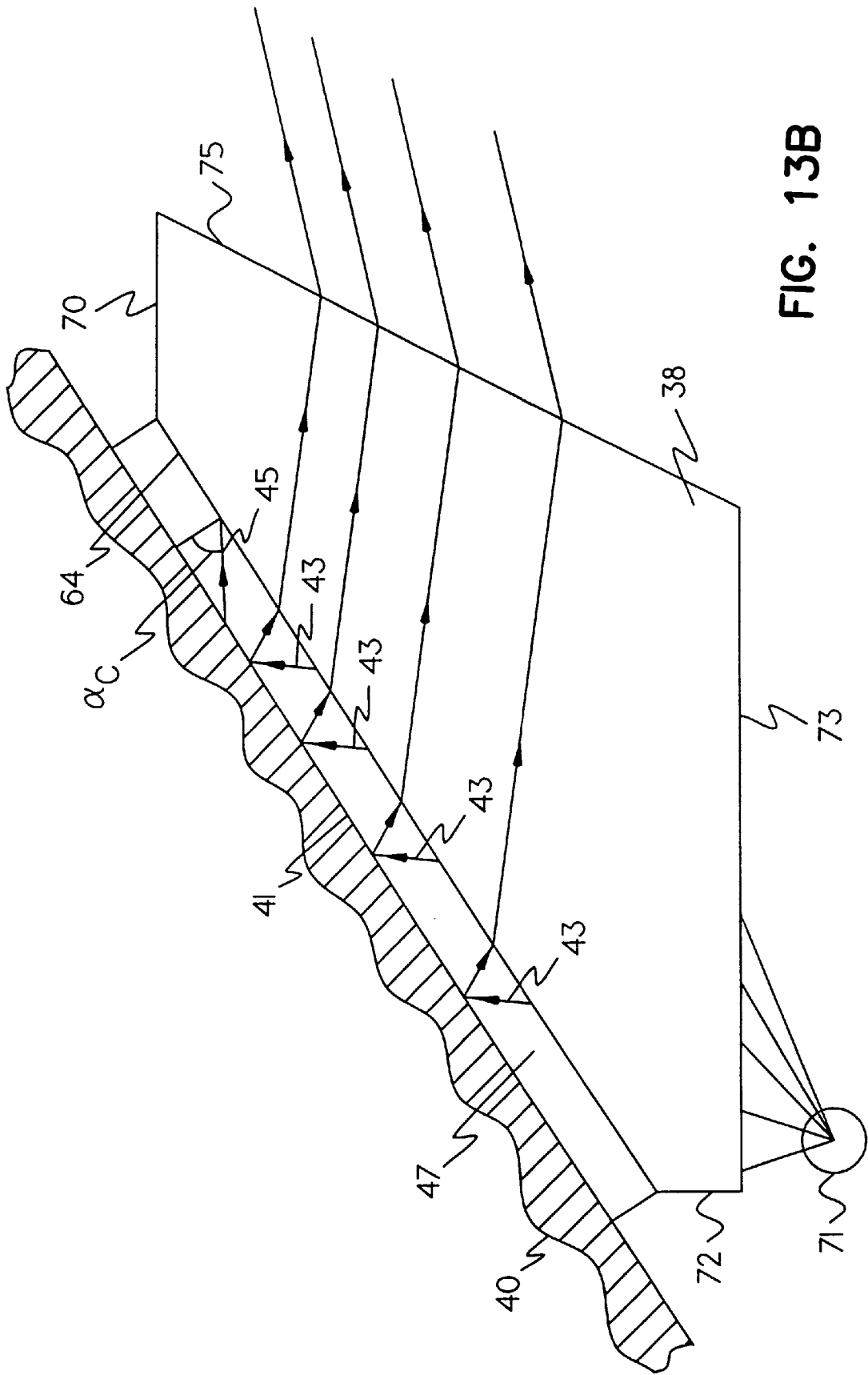

FIG. 13B

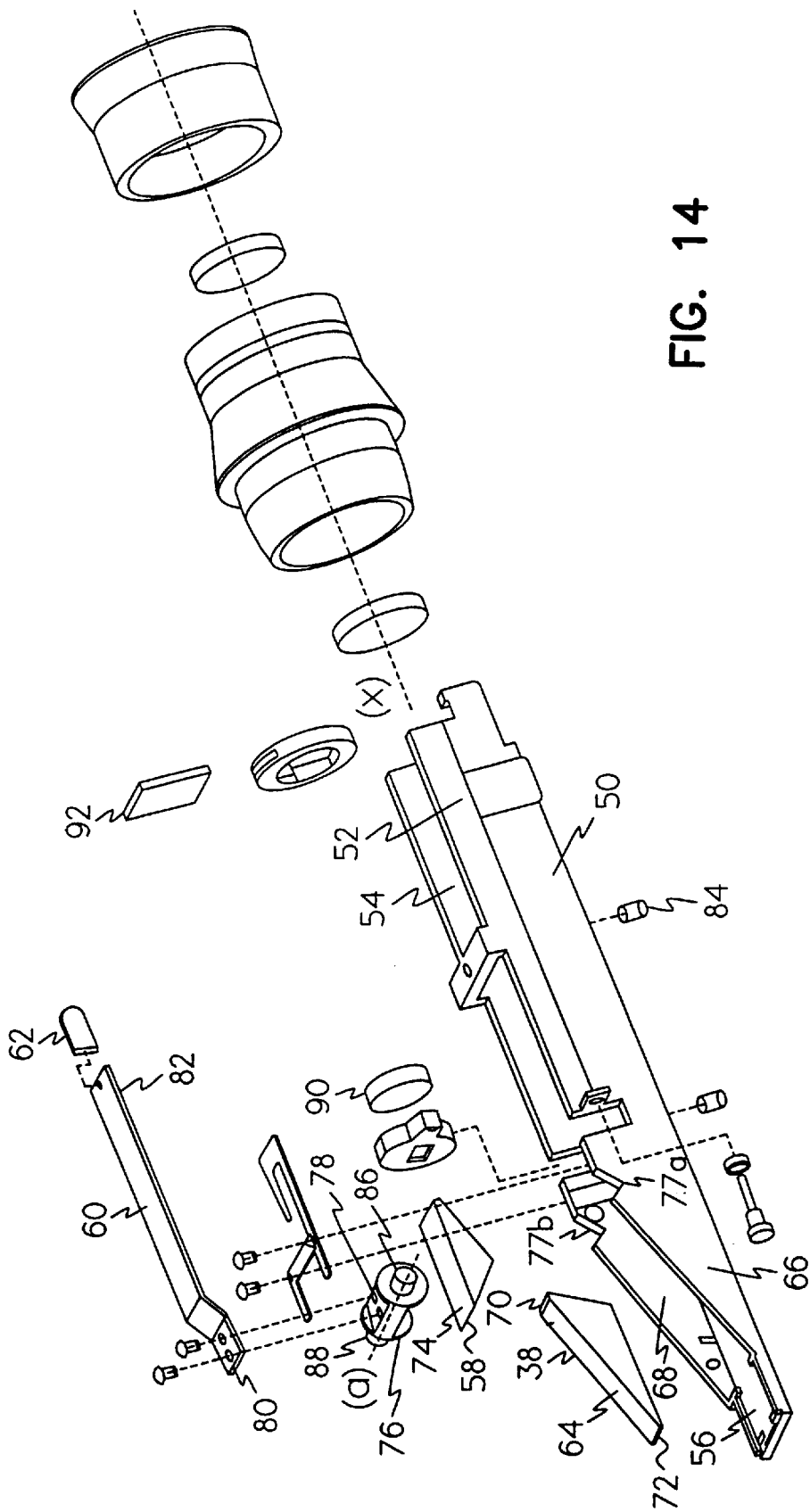

FIG. 14

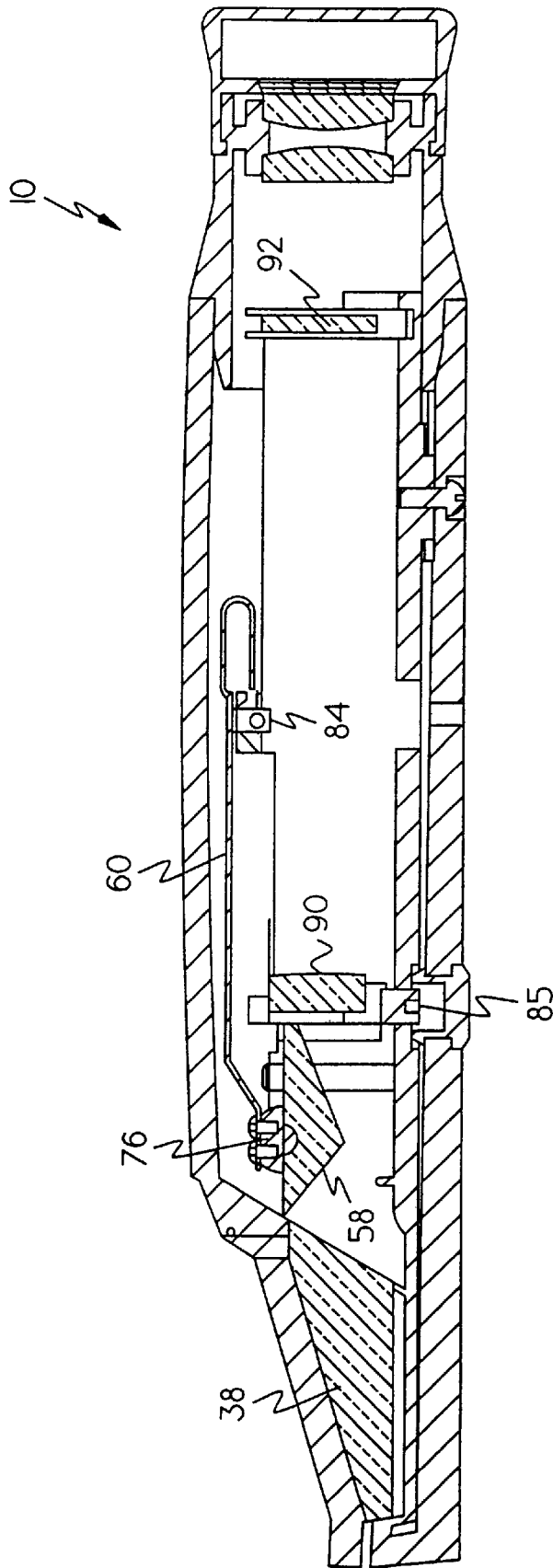

FIG. 15A

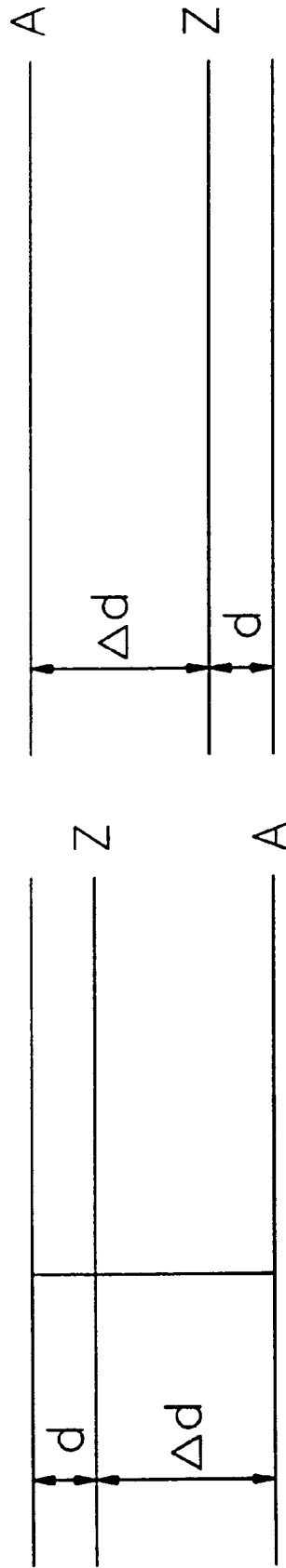

FIG. 15B

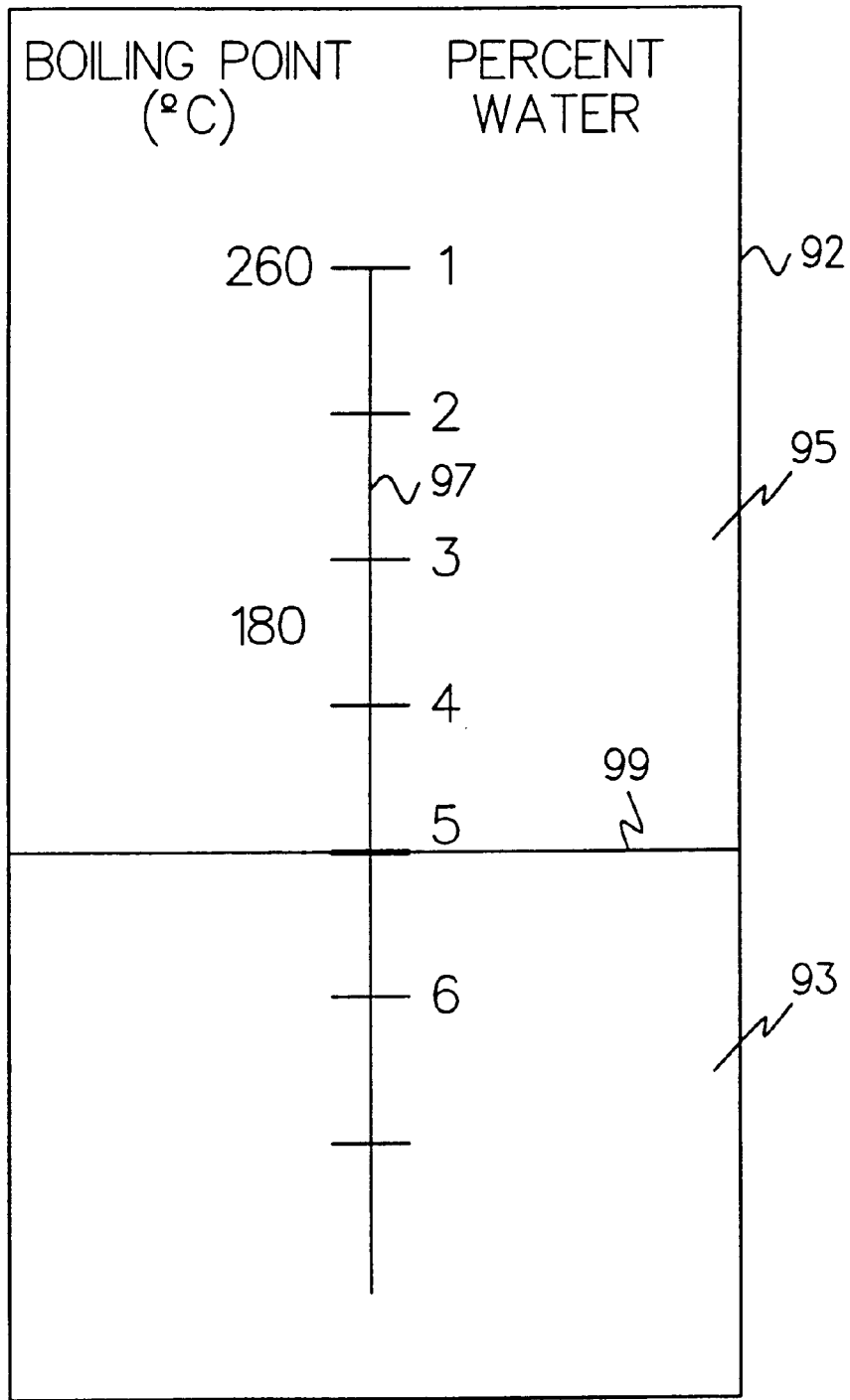

FIG. 15C

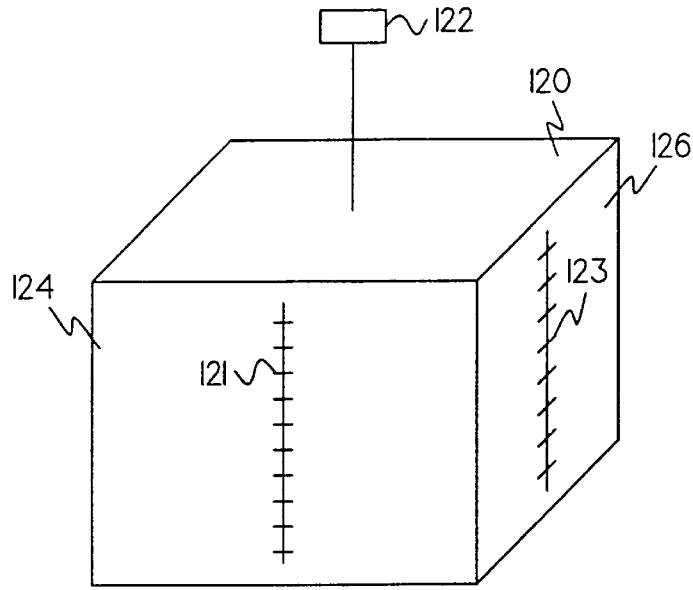

FIG. 15D

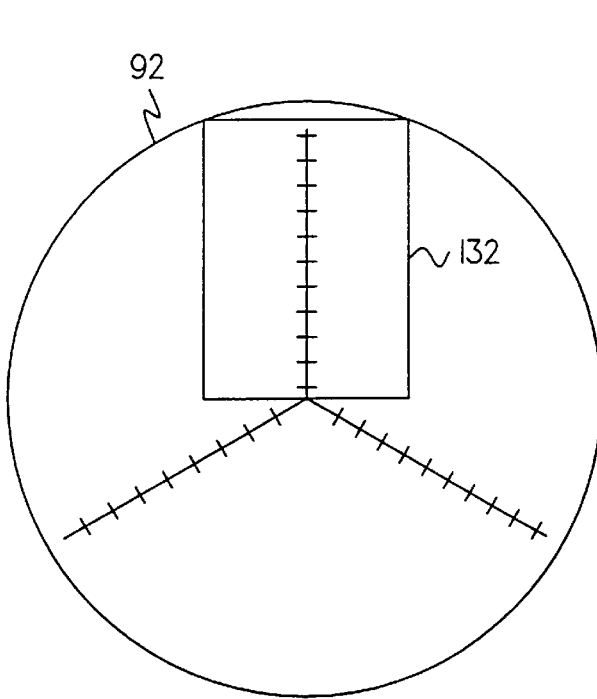

FIG. 15E

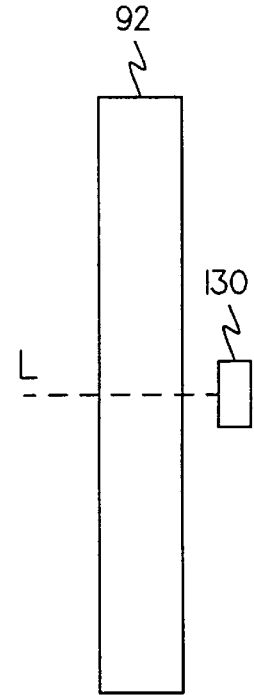

FIG. 15F

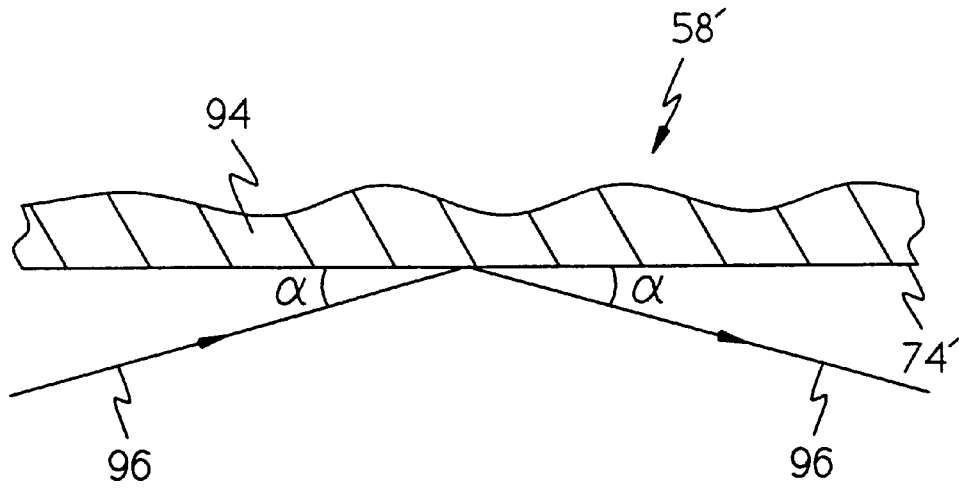

FIG. 16A

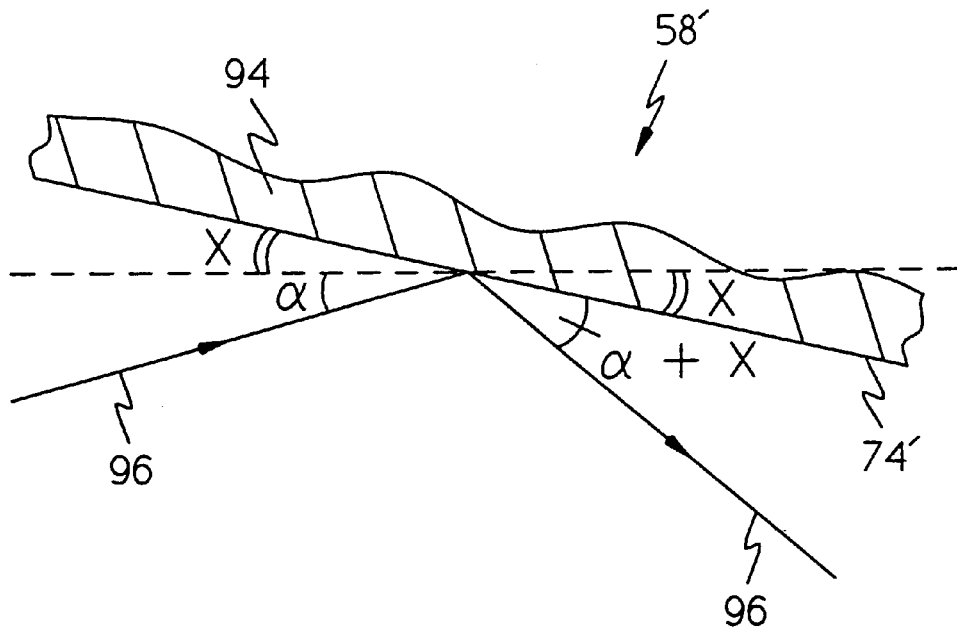

FIG. 16B

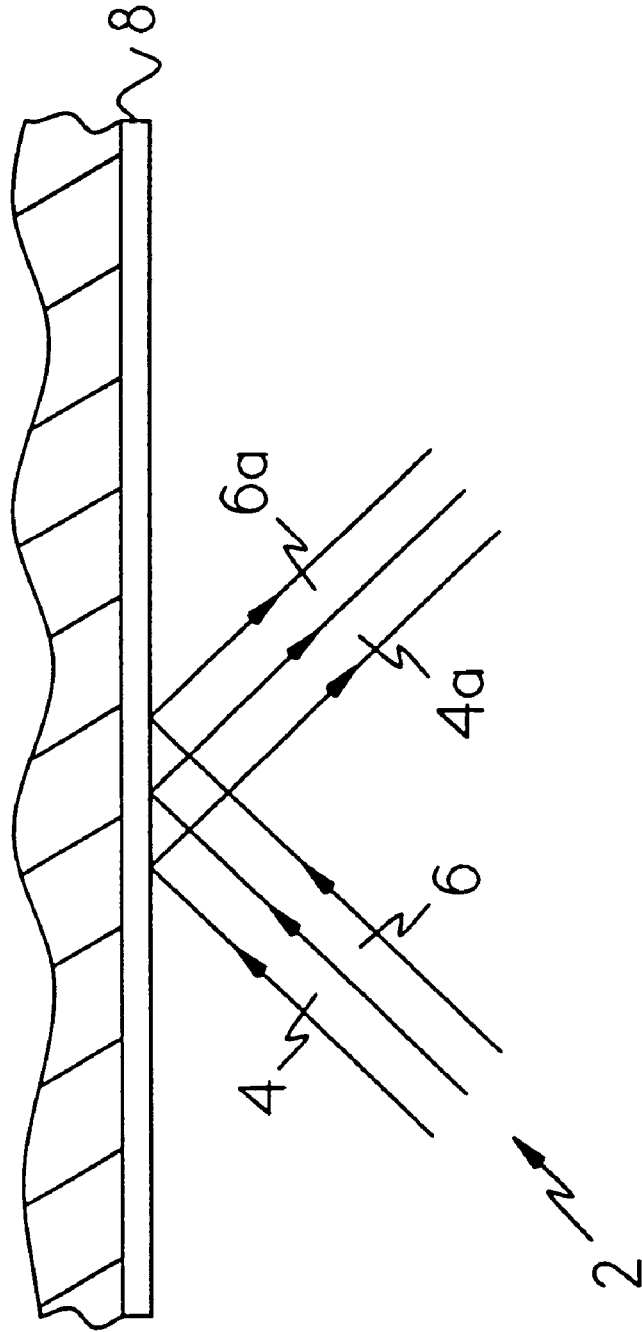

FIG. 17

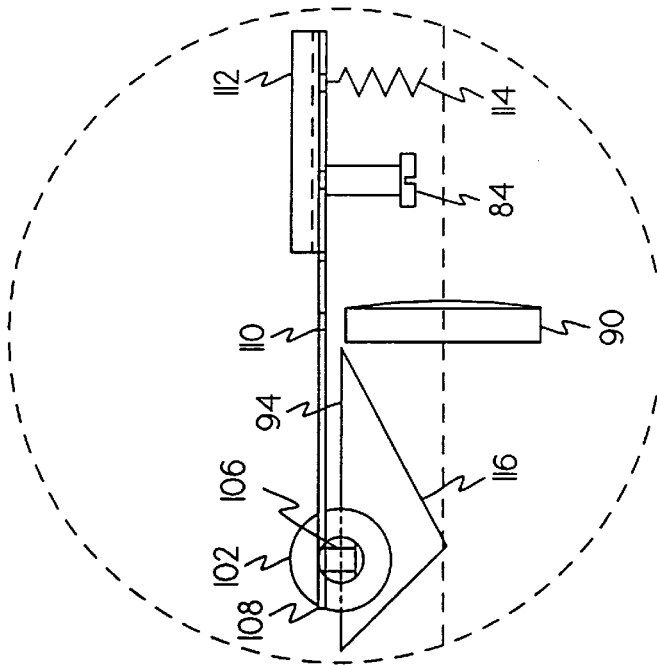

FIG. 18A

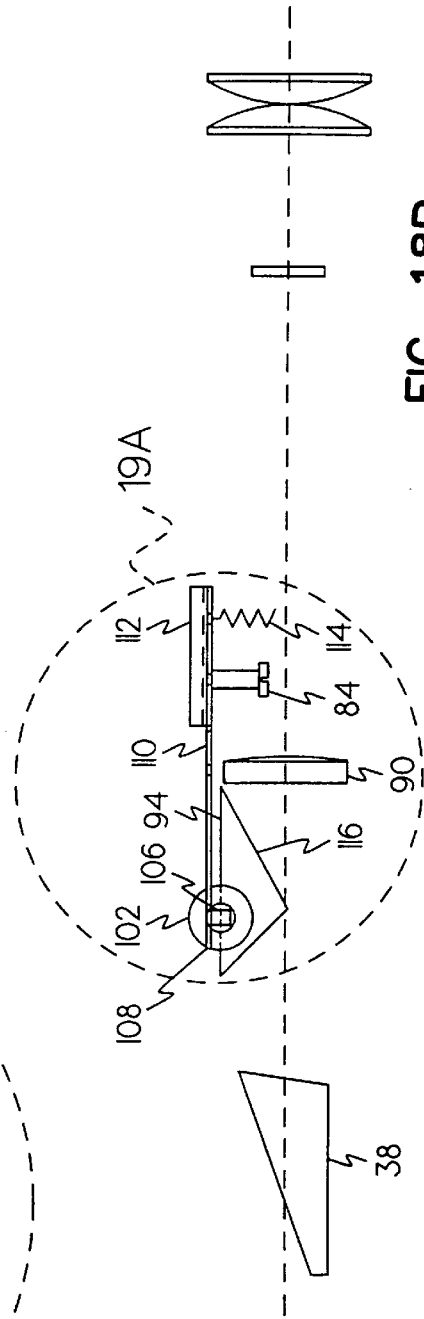

FIG. 18B

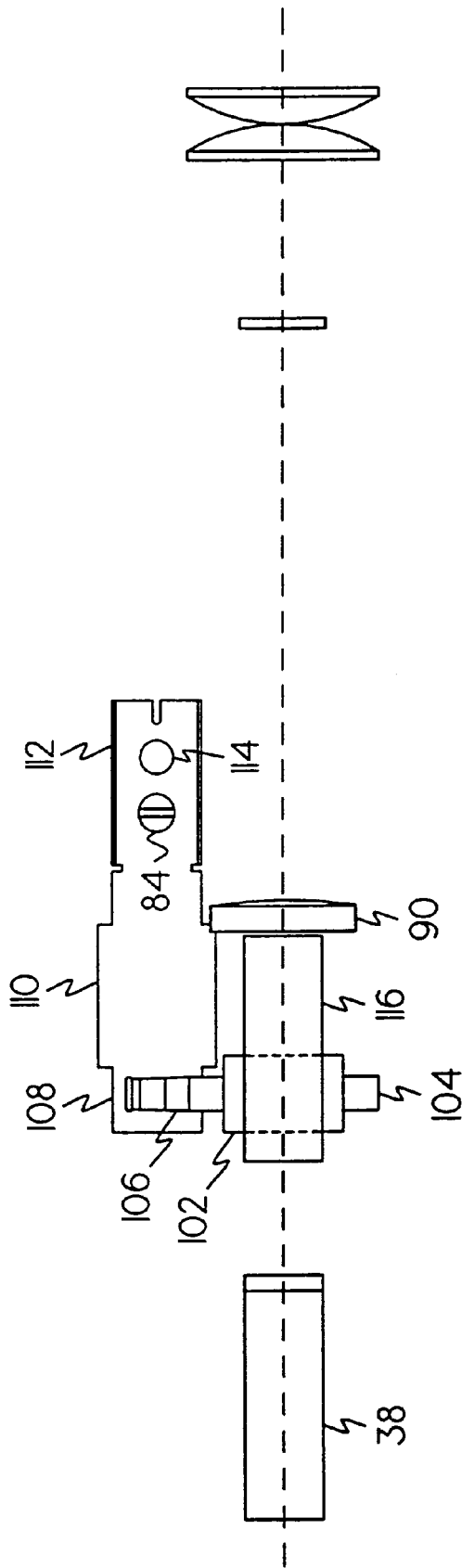

FIG. 18C

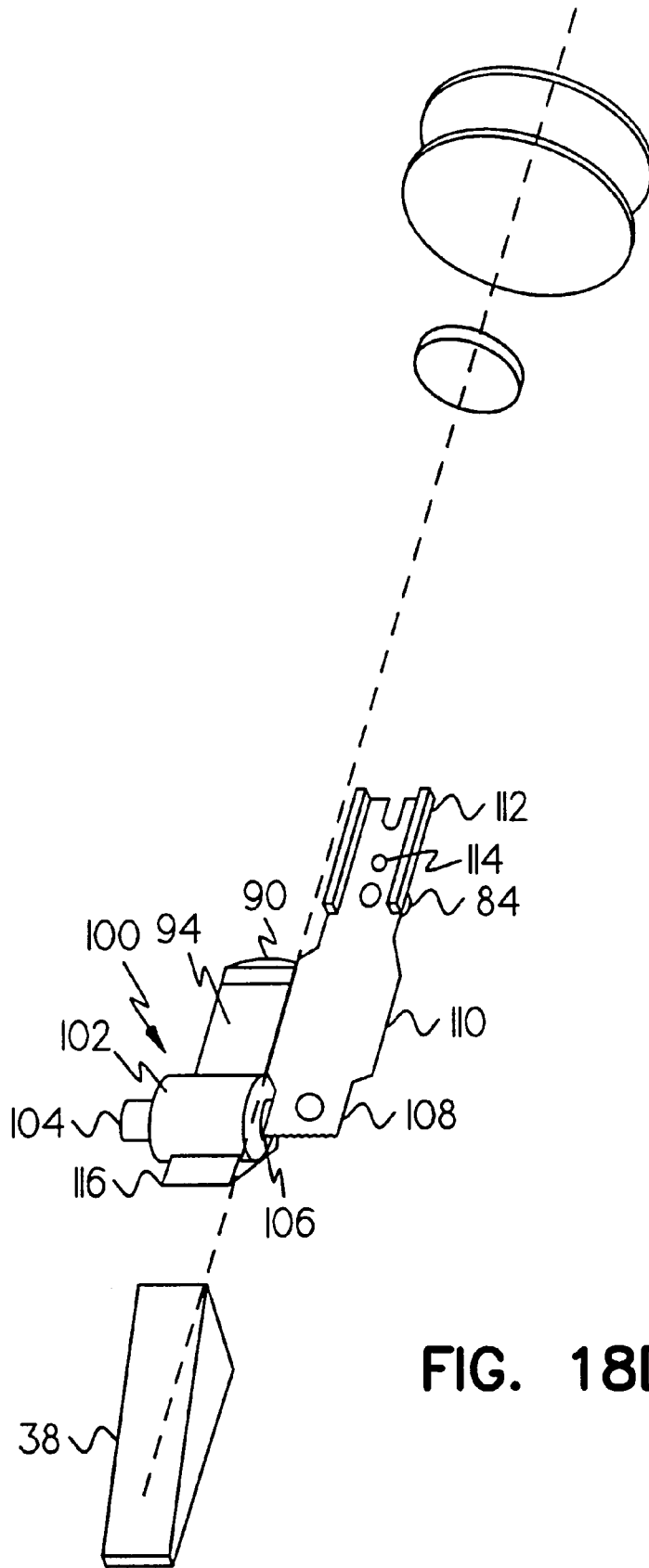

FIG. 18D

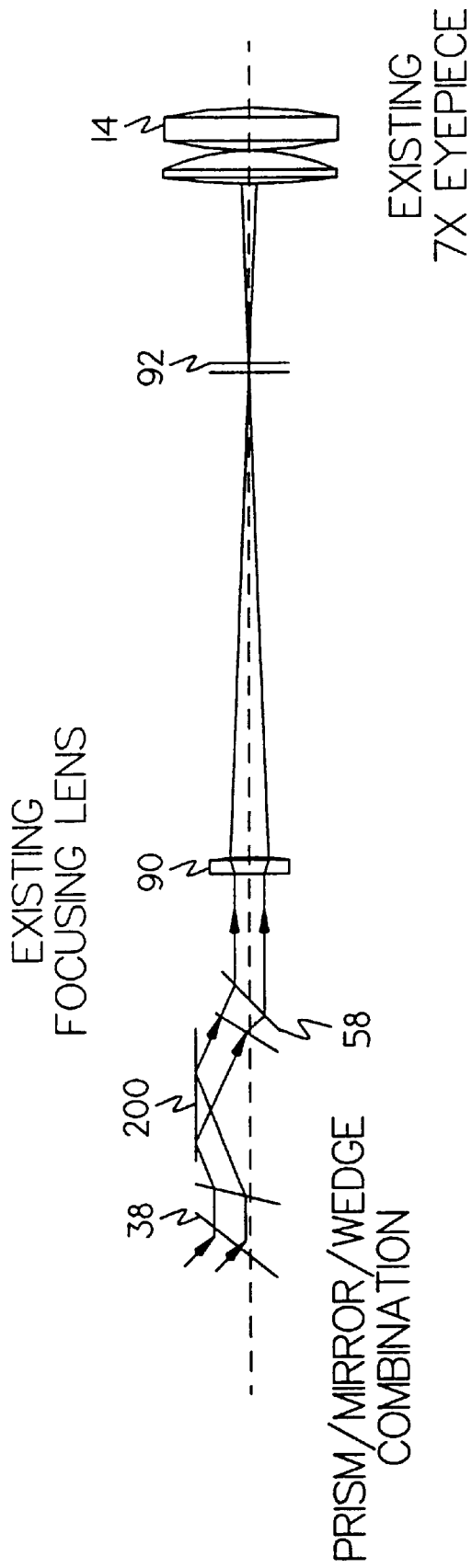

FIG. 19

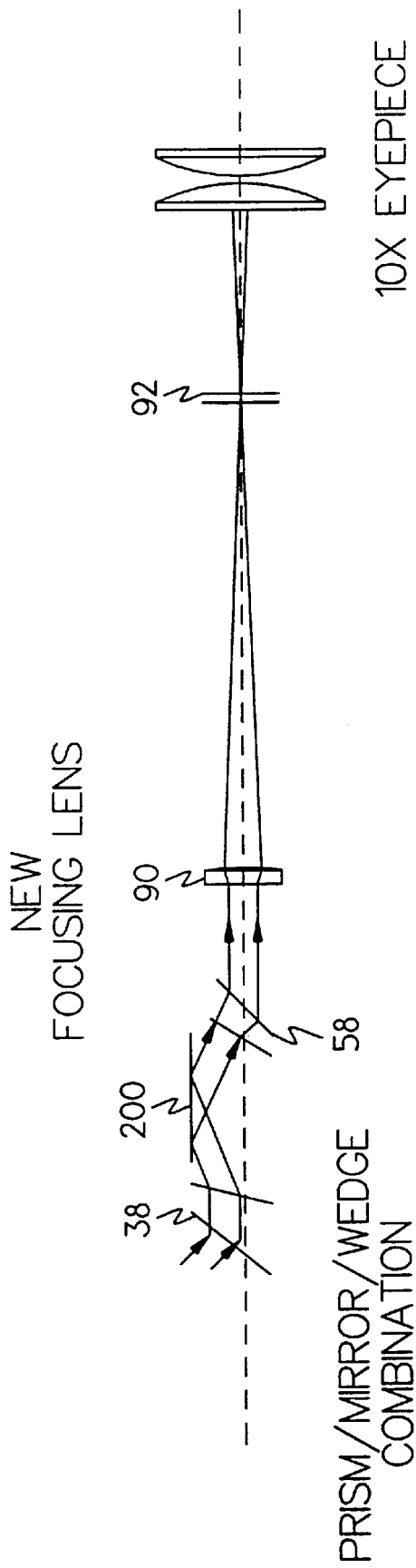

FIG. 20

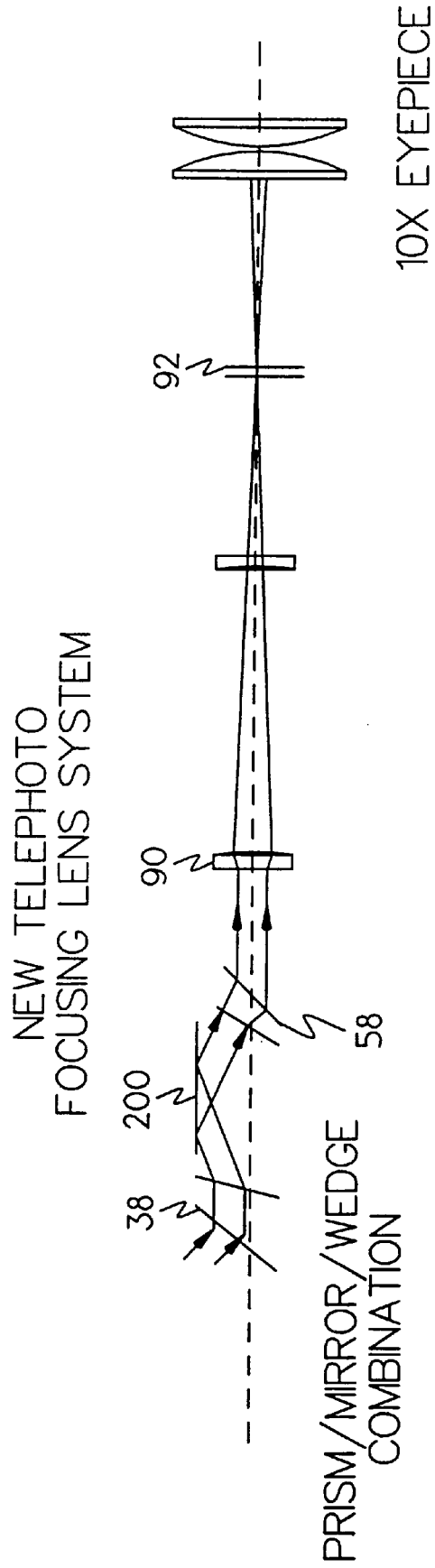

FIG. 21

## BRAKE CHECK HANDHELD REFRACTOMETER

### CROSS-REFERENCE TO A RELATED APPLICATION

This application is a continuation-in-part of an earlier filed co-pending patent application Ser. No. 09/097,368 (still pending), filed on Jun. 15, 1998, which is incorporated herein by reference.

### BACKGROUND OF THE INVENTION

Monitoring the water content in hydraulic brake fluids is known to be of crucial importance in maintaining efficient and effective braking function. During the braking, especially the sustained braking, friction-generated heat can cause a brake fluid to boil and form vapor bubbles that can cause a complete loss of the braking function. Since most of the commercially used brake fluids are highly hygroscopic, the water content in such a fluid can increase due to water absorption from the surrounding environment. If the water content in a brake fluid increases to 2%, the boiling point of the fluid decreases significantly, thus, decreasing the efficiency of the brakes and overall safety of the operating device.

Another area of concern related to the high water content in brake fluids is the increase of the fluid's corrosive activity that can cause corrosion of the braking system components that come in contact with the brake fluid. Antilock braking systems (ABS) that are presently installed on many motor vehicles are especially susceptible to corrosion. Having water in a brake fluid during the period of about 2 years irreparably damages an ABS unit. A replacement for an ABS unit presently costs about \$1,800.

Two methods of measuring water content in a brake fluid are employed in the products currently available on the market. The Karl Fisher titration method is used in a complicated device that costs around \$7,000. Another type of a device that uses the method of measuring the boiling point of a brake fluid costs about \$1,000. It is obvious that the majority of service stations will not be able to afford and use expensive measuring devices. Yet another method of determining water content in brake fluids by measuring conductivity of a fluid has proven to be inaccurate. Therefore, it is highly desirable to have a quick, easy and inexpensive method and device for determining water content in a brake fluid. Such method and device would allow service technicians to measure water contents in brake fluids and recommend brake fluid changes before either safety or corrosion concerns arise.

Refractometers have long been used as field instruments for a variety of applications. They have been useful in determining sugar content in grape juices, water content in honey, the concentration of water soluble metalworking lubricants and protein levels in blood serum. American Society of Testing and Materials Standard Practice D 3321 details use of a refractometer for determining the freeze point of engine coolants with far greater accuracy than traditional hydrometer methods. Refractometers require a very small sample size. Refractive index measurements are quick and can be performed with simple, relatively inexpensive instruments. Therefore, refractometry can be used to determine a percentage of water in fluids by measuring the critical angle of total reflection in a particular fluid while providing for temperature compensation that becomes necessary due to the temperature dependence of the refractive indices. Since the refractive index  $n$  of a fluid changes as the

water content increases, fluids with different water contents will have different refractive indices, and, therefore, different critical angles of total reflection. Due to the phenomenon of total reflection there will be a boundary between the dark and light portions of a scale in the observation area. The location of the boundary on the scale than is calibrated in water content units will indicate the percentage of water in a tested sample of a fluid.

Refractometers that use the critical angle of total reflection to determine percentages of water in such substances as antifreeze coolants have been known in the industry. For example, U.S. Pat. No. 5,355,211 to Thompson et al. (assigned to Leica, Inc.) discloses a refractometer sub-assembly method and apparatus comprising critical angle prism **214** and compensating wedge **232** disposed within housing **210**, as shown in FIG. of that patent. Wedge **232** is attached to one end of temperature responsive member **234**.

U.S. Pat. No. 4,243,321 "Handy Refractometer" to Okuda et al. discloses a handheld refractometer, as particularly illustrated in FIGS. **1** and **5** of that patent. The patent discloses mirror **12**, one end of which is secured to holding member **14** for prism **3** by plate spring **13**. The other end of mirror **12** is urged against thermally expansible member **15** by the force of spring **13**. As temperature changes, the thermally expansible member expands or contracts, thereby rotating the mirror **12**. In the Okuda patent rotation of mirror **12** about the pivot P keeps beam **53** parallel to original beam **52** in order to compensate for a temperature change.

U.S. Pat. No. 4,451,147 "Refractometer" to Dobes et al. discloses a refractometer that utilizes light refracting wedge **40**, mirror **18**, mirror surface areas **32** and **44**, and prism **22**, as illustrated in FIGS. **1**, **2** and **3** of that patent. According to the Dobes patent, mirror **18** reflects beam **54** and directs it to prism **22**. At the lower side of prism **22** the beam splits into reference light beam **56** and measuring light beam **58**. Reference light beam **56** is then reflected by mirror surface **32** of prismatic body **42** and by partial mirror surface area **44** of light refracting wedge **40**. Measuring light beam **58** gets refracted at active surface area **34**, and passes through light refracting glass wedge **40** to be reflected by a mirror surface at the lower side **60** of wedge **40**. Temperature compensation in that patent is achieved by directing both reference and measuring beams through the same prism, thus, exposing the two beams to the same temperature differences. For the Dobes invention to operate prism **22** has to be partially coated with a reflective coating.

Due to the nature of certain chemicals contained in brake fluids, there are two problems that are specific to brake fluids and that render the known refractometers completely inapplicable to measuring refractive properties of such fluids.

First, the range of the refractive index  $n$  in a brake fluid spans from about 1.4447 at 0% of water to about 1.4394 at 7% of water. This range is much narrower than that of a coolant (spanning from about 1.33 to about 1.38 over the same range of the percentages of water). Thus, a much more sensitive device reflecting a different refractive index range is necessary to design a brake fluid refractometer. The increased sensitivity requirement can be satisfied by achieving more accurate temperature compensation. The known method of temperature compensation employed in a refractometer for coolants uses a bimetallic strip attached to a temperature compensating prism (called "a wedge" in the following description of the present invention) and to the prism on which a sample fluid is deposited. The material of the compensating prism is such that its temperature coefficient ( $dn/dT$ ) is negative if the temperature coefficient of the

sample fluid is positive, and vice versa. The bimetallic strip deflects from its initial position when temperature changes, changing the angle of the attached compensating prism and, thus, providing for the correct temperature compensation in measuring the refractive index of a sample fluid.

The concept of using two materials with opposite temperature coefficients and a bimetallic strip has been known and used in the industry. It is described, for example, in U.S. Pat. No. 3,329,060 to Holleran and U.S. Pat. No. 3,267,795 to Goldberg which are incorporated herein by reference.

Such a design for temperature compensation proved to be unworkable in the case of measuring water contents in brake fluids. The temperature coefficient of a brake fluid is approximately 3 times smaller than the temperature coefficient of a coolant ( $-38 \times (10)^{-5}/^\circ\text{C}$ . for a brake fluid,  $-12 \times (10)^{-5}/^\circ\text{C}$ . for a coolant). Therefore, a much more sensitive temperature compensation device is needed to measure water content in a brake fluid over a temperature range typical for a regular service station. Because of the increased sensitivity requirements a bimetallic strip used in the refractometer for coolants can not provide the necessary angular compensation. Therefore, a new temperature compensation device is needed for a brake fluid refractometer.

A second problem arises from the fact that in a brake fluid the refractive index changes negatively with the increase of the water content, whereas, for example, in a coolant the refractive index increases with the increase of glycol. Thus, there exists a need of inverting the image on the reading scale so that the bottom of the scale will correspond to 0% of water and the top of the scale will correspond to 7% of water in a brake fluid. Such inversion is highly desirable because the bottom-to-top calibration is familiar to the customers and has been used in already existing coolant refractometers.

It is also greatly desirable to have a refractometric apparatus that would allow a user to determine not only the percentage of water in a particular hydraulic fluid, but also the boiling point of such a fluid. Such an apparatus would be especially useful, for example, in servicing race cars, because for servicing such cars properly it is the boiling point that needs to be determined in order to prevent the loss of the braking function.

#### SUMMARY OF THE INVENTION

It is therefore, a primary of the present invention to provide a refractometric apparatus and method for use with a hydraulic fluid, such as brake fluid, which solves the above enumerated problems. The present invention provides a refractometric apparatus and method employing a temperature sensitive member that provides correct readings of the water content and a boiling point on the reticle. In particular, the temperature sensitive member comprises a prism-wedge-mirror combination in conjunction with a bimetallic strip.

In a particular embodiment of the present invention the use of a mirror achieves the increased angular deviation of the beam. Changing the position of the mirror changes the angular deviation of the beam in ratio 2 to 1. Therefore, a more sensitive temperature compensation in a brake fluid refractometer is achieved by introducing a mirror between the prism with a sample of a hydraulic fluid and the wedge. In a coolant refractometer, the old temperature compensation combination without a mirror lead to an angular displacement of the beam of only a fraction of  $1^\circ$  when a wedge rotated  $1^\circ$ .

It is another object of the present invention to stretch a narrower range of brake fluid refractive indices over a larger

scale than is normally used in refractometers for coolants. A larger angular displacement carried over the distance between the focusing lens and the reticle will provide a larger span of an image on the scale of the reticle.

It is yet another object of the present invention to achieve image inversion in a refractometer for brake fluids. The portion of the beam that previously got totally reflected on the boundary between the sample fluid and the prism and the portion of the beam that did not get totally reflected change places after the beam is reflected by the mirror, thus, inverting the image that a user will subsequently see on the scale.

And yet another object of the present invention is to incorporate a novel reticle into a hydraulic fluid refractometer. The new reticle comprises one or more scales that indicate, for example, the percentage of water in and the boiling point of a particular hydraulic fluid.

And another object of the present invention is to provide a kit comprising at least two refractometers for use with corresponding hydraulic fluids.

These and other objects and advantages of the present invention will become increasingly more apparent to those skilled in the art by reference to the following description and to the accompanied drawings.

#### BRIEF DESCRIPTION OF THE DRAWINGS

FIG. 1 is a chart illustrating values of absolute refractive indices and temperature coefficients of a number of new brake fluids.

FIGS. 2A, 2B and 2C are graphs illustrating the relationship between refractive index and water content and boiling point of various brake fluids;

FIG. 3 is a graph illustrating the relationship between boiling point and water as determined by the Karl Fischer titration method;

FIG. 4 is a chart including data on results obtained in determining average water concentration and refractive index from the information in FIGS. 2 and 3;

FIG. 5 is a graph illustrating dependency of refractive indices of brake fluids on percentage of water;

FIG. 6 is a table presenting average temperature coefficient of various brake fluids;

FIG. 7 is a chart presenting data on refractive indices and temperature coefficients of used brake fluids;

FIG. 8 is a histogram showing water content in brake fluid of various vehicles;

FIG. 9 is a perspective view of several containers including brake fluid samples;

FIG. 10 is a histogram illustrating a distribution of color intensities in the samples of used brake fluids of FIG. 9;

FIG. 11 is a graph comparing refractive index readings to water content for various used brake fluid samples;

FIG. 12 is a graph comparing the data of FIG. 11 to the data of FIGS. 2A and 2B;

FIG. 13 is a perspective view of the brake fluid refractometer of the present invention;

FIG. 14A is an exploded view of a portion of the refractometer of FIG. 13;

FIG. 14B is a schematic representation of refraction if a critical angle prism illuminated by an LED;

FIG. 15 is an exploded view of components of the refractometer of FIG. 13;

FIG. 16A is a longitudinal sectional view of the refractometer of FIG. 13;

FIG. 16B is a schematic illustration of the calibration procedure;

FIG. 16C is an example of a reticle showing a reading;

FIGS. 16D and 16E illustrate different embodiments of a reticle of the present invention;

FIG. 16F is a side view of a disk-shaped reticle of the present invention;

FIGS. 17A and 17B are diagrammatic illustrations of the operation of the one-piece mirror-wedge combination of the present invention;

FIG. 18 is a diagrammatic view illustrating the image inversion in the refractometer of the present invention;

FIGS. 19A–19D are exploded views, partly diagrammatic, illustrating an alternative embodiment of the refractometer of the present invention; and

FIGS. 20–21 are diagrammatic views illustrating further embodiments of the brake fluid refractometer of the present invention.

#### DETAILED DESCRIPTION OF THE PREFERRED EMBODIMENT

Brake fluids circulating in different makes of motor vehicles made and driven in countries around the world come in a wide variety of combinations of chemicals. Various makes of cars built by a particular manufacturer as well as cars of the same class built by different manufacturers require different types of brake fluids to maintain proper and reliable braking function. The variety of types of brake fluids makes the task of designing a single device for measuring certain properties of different brake fluids an especially daunting problem. Therefore, in order to design and build a refractometer that relates the refractive index  $n$  to the boiling point and a percentage of water in a population of brake fluids available on the market, it is necessary to assure that the optical properties of various brake fluids are such that the refractive indices of the fluids are still within the range that is adaptable to obtaining a clear reading on the reticle. The following tests and measurements performed on “clean” brake fluids diluted with water and brake fluids taken from actual motor vehicles illustrate and support the concept of adaptability of a brake fluid refractometer of the present invention to determining water content and boiling points of different brake fluids.

#### EXAMPLE 1

The Range of Absolute Refractive Indices in Brake Fluids

The chart of FIG. 1 illustrates the values of absolute refractive indices of 33 new brake fluids as well as the refractive indices of the same brake fluids diluted by water up to 7% with an increment of 1% of water in most experiments. An absolute refractive index of a fluid is its refractive index at 0% of water in the fluid. In this example various brands of brake fluids were purchased at a store, then an absolute refractive index of a pure, undiluted brake fluid was measured. After that, refractive indices of diluted samples of brake fluids were determined. In all measurements the refractive indices were measured on a NIST Traceable laboratory refractometer. The percentage of water in the samples were determined by the Karl Fisher titration method that is well-known to those skilled in the art.

Brand names and types of the brake fluids and the percentages of water in these fluids are provided in Columns 1, 3 and 4 in FIG. 1. Column 8 provides refractive indices for all pure brake fluids as well as brake fluids diluted by water up to 7% at 20° C. It can be seen from Column 8 that at 20° C. the absolute values of refractive indices lie within

the range between about 1.44721 for the DOT 4+ Volvo brake fluid brand and about 1.44344 for the DOT 3 Delco (GM) brand. The fact that all the absolute refractive indices fall within such a range makes that range convenient for obtaining a good reading on a reticle of the refractometer. Therefore, the above data conclusively show that it is possible to build a refractometer which is capable of providing accurate readings for a variety of different brake fluids.

#### EXAMPLE 2

The Relationship Between Refractive Index, Water Content and Boiling Point of Brake Fluids

The relationship between refractive index and water concentration for DOT 3, High Temperature DOT 3 and DOT 4 brake fluids is shown in FIGS. 2A, 2B and 2C, respectively. Water in amounts of 1% to 8% water in increments of approximately 1% was added to each new fluid to develop these data. Refractive indices were measured at approximately 20° C. and 24° C. and were corrected to 20° C. All three types of brake fluid exhibited excellent correlation between refractive index and water concentration despite the fact that the composition from fluid to fluid within a category may vary. The curve fitted data in FIGS. 2B and 2C are almost identical. This demonstrates that there is no appreciable difference between the refractive index and water concentration correlation for the High Temperature DOT 3 and DOT 4 fluids. The boiling points of a smaller number of fluids were also determined over a 1% to 6% water concentration range. The relationship between boiling point and water content as determined by Karl Fischer titration is shown in FIG. 3. The results from FIGS. 2 and 3 were used to determine average water concentration and refractive index at the specified wet and dry boiling points for DOT 3 and DOT 4 fluids. These results are presented in the chart of FIG. 4 along with the average boiling point, % water and refractive index for fluid fresh from the container. All of the studied fluids greatly exceeded the minimum wet and dry boiling points specified by Society of Automotive Engineers J1703 and Department of Transportation Motor Vehicle Safety Standard No. 116. The dependency of the refractive indices of DOT 3, Ford DOT 3, and DOT 4+ types of brake fluids on the percentage of water is also illustrated in FIG. 5. It follows from the graph in FIG. 2 that the decrease of the refractive indices with the increase of water is generally constant in all tested brake fluids. In other words, the slope  $dn/d(\%H_2O)$  of the curves in FIG. 2 is constant over the range from about 1% to about 5% of water.

The fact that in all of the tested brake fluids the refractive indices decrease at about the same rate makes it possible to design a brake fluid refractometer with a reticle that will provide accurate readings of water content and the boiling points for a wide variety of brake fluids available on the market.

#### EXAMPLE 3

Temperature Coefficient and Dispersion in Brake Fluids

Temperature has a large effect on refractive index measurements and must be controlled or corrected very carefully. Aqueous solutions generally exhibit a temperature coefficient of  $-0.0001$  to  $-0.0002$ . The temperature coefficient of organic liquids is approximately  $-0.0004$ . Such a coefficient corresponds to about 0.5% change in concentration per degree centigrade. The temperature coefficients of new DOT 3, High Temperature DOT 3 and DOT 4, brake fluid were identical. The average temperature coefficient of a sampling of used DOT 3 brake fluid is also identical. Temperature coefficient data are shown in the chart of FIG.

6. Turning back to the chart of FIG. 1, Column 14 represents the results of the measurements of differential temperature coefficients  $dn/dT$  for all of the tested brake fluids. These coefficients fall within the range of about  $-30 \times 10^{-5}/^{\circ}\text{C}$ . to  $-50 \times 10^{-5}/^{\circ}\text{C}$ . The average value of the temperature coefficient was determined as  $-0.000388416/^{\circ}\text{C}$ . The average value of the temperature coefficient accurately reflects the changes of the refractive indices  $n$  for the tested fluids as the temperature of the environment increases or decreases. Because the temperature coefficient stays about the same, it was possible to devise a single temperature compensation system for the refractometer of the present invention. Such a system compensates for temperature changes in the refractive indices in all of the variety of brake fluids.

A related important property of brake fluids discovered and implemented in the present invention is their constant dispersion. Dispersion reflects the change of the refractive indices with respect to the wavelength of the incident beam of light,  $dn/d\lambda$ . If the dependence of refractive indices on the wavelength were not constant, it would be impossible to get a reading on the scale of the output device of the refractometer in the form of a sharp boundary. Dispersion would cause light of different wavelengths to be refracted at different angles, therefore, producing a multicolored boundary incapable of indicating a particular value corresponding to the refractive index. It turned out that in the tested brake fluids the ratio  $dn/d\lambda$  remained constant for different formulations of brake fluids. Therefore, the reading formed on the reticle of the refractometer was in the form of sharp boundary between light and dark areas. Such a reading is perfectly suitable for accurately representing the values of the percentages of water and boiling points of brake fluids measured by the refractometer of the present invention.

#### EXAMPLE 4

##### Similarity Between "Clean" and "Used" Brake Fluids

Measurements of water content and boiling points of different brake fluids were performed on "clean", new fluids bought in a store and later diluted with water. Obviously, in real life the new brake fluid refractometer is going to be used to determine the same parameters in "used" brake fluids, the ones removed from cars after use. It is important, therefore, to establish that the optical properties of "new" and "used" brake fluids that have the same water content are similar. If such a similarity of the reticle readings corresponding to a tested "clean" brake fluid with a certain percentage of water and to a "used" brake fluid with the same percentage of water is proven, then the conclusion is that the refractometer of the present invention will show the correct readings for various brake fluids from cars in use and tested by technicians and service people at different car service establishments.

Turning now to the chart of FIG. 7, it can be seen that the data therein represent the measurements of the refractive indices and temperature coefficients of "used" brake fluids, the same optical properties that were measured and presented in the chart of FIG. 1 for "clean" brake fluids. The master cylinder brake fluid water content of 131 vehicles was analyzed. The reservoir cap of all the vehicles tested recommended DOT 3 Brake fluid. A histogram of the results is shown in FIG. 8. The average water concentration in the vehicles tested was 2.6%  $\pm$  1.5%. The vehicles ranged in year from 1976 to 1997. Average age of the vehicles was 8 years  $\pm$  4 years. The median water content was 2.4%. In 60% of the vehicles the measured water content was greater than 2%. Twenty-five percent of the vehicles had a water content greater than 4%, near the wet equilibrium reflux boiling point of typical DOT 3 brake fluid.

The physical appearance of the fluids tested varied greatly from sample to sample. The representative range of color of the samples is depicted in FIG. 9. A subjective analysis of the color of the samples is shown in FIG. 10. There was no indication that the color or darkness of the samples contributed to any variability in the analysis. Calculated correlation coefficients for refractive index versus % water were identical even when the darkest samples were excluded.

The data shown in FIG. 11 includes all samples, regardless of color. FIG. 11 compares refractive index readings to water content for 125 "in use" road vehicles. No attempt was made to differentiate between standard DOT 3 and High Temperature DOT 3 used brake fluids. A curve for the used brake fluid data falls between the curve fit lines for clean standard DOT 3 and high temperature DOT 3 fluids as shown in FIG. 12.

The refractive indices of the "used" brake fluids fell within the range of 1.43907 to 1.44588, which is practically identical to the range of the refractive indices observed for diluted brake fluids in Example 1. Moreover, the "used" and diluted "clean" brake fluids containing the same percentage of water had approximately the same refractive indices and temperature coefficients.

Therefore, examples 1-4 show that optical properties of a wide variety of commercially available brake fluids used in different makes of cars are such that a single measuring device providing accurate readings of the percentages of water and boiling points of the brake fluids can be designed. The present invention implements the principles illustrated by examples 1-4 in a brake fluid refractometer.

Turning now to FIG. 13, there is shown a brake fluid refractometer 10 of the present invention comprising a one-piece housing 12 and an output reading device 14. Output reading device 14 can be of any convenient type, such as, for example, a digital output reading device, which allows a user to view the result of a measurement in a digital form. It is contemplated by the present invention that a hydraulic fluid refractometer with a digital output reading device can comprise an array of photosensitive elements for sensing the amount of illumination of the array by incident light.

As illustrated in FIG. 14A, housing 12 includes an elongated cylindrically shaped handle portion 16 and a reference portion 18 having first and second sloping surfaces 20 and 22, respectively, and a horizontal surface 24 extending and meeting with spaced apart side walls 26 and 28. Sloping surfaces 20 and 22 and spaced apart side walls 26 and 28 join with cylindrically shaped handle portion 16 to form one-piece housing 12 in which optical elements of refractometer 10 are to be disposed.

First sloping surface 20 includes a protrusion 30 having a through bore 32 which is adapted for receiving a hinge means 34. Second sloping surface 22 includes a rectangular opening 36 that allows to deposit a sample fluid on a surface of a critical angle prism 38 (shown in FIG. 15) disposed inside housing 12 and described in detail below. Hinge means 34 in the form of a rod is provided for pivotally connecting cover 40 to protrusion 30 and to allow cover 40 to be in an open position when a sample fluid is being deposited on the critical angle prism, or in a closed position after the sample fluid has been deposited on the critical angle prism. Cover 40 consists of two sloped surfaces 42 and 44 and a third surface 46 which are shaped to cover surfaces 20, 22, and 24 of housing 12 when cover 40 is in the closed position.

Turning now to FIG. 15, within housing 12 there is located a channel-like frame 50 consisting of two spaced

apart side panels 52 and 54 connected to a bottom panel 56. Frame 50 serves as a receptacle for optical elements of the refractometer, comprising critical angle prism 38, a wedge 58, a bimetallic strip 60, and a bimetallic spring means 62. Critical angle prism 38 is disposed within frame 50 between spaced apart side panels 52 and 54 in such a way that a sloping face 64 of critical angle prism 38 is situated in between two sloping ribs 66 and 68 of frame 50 and below second sloping surface 22 of reference portion 18 of housing 12 having rectangular opening 36. A sample fluid is usually deposited on sloping face 64 of critical angle prism 38 through rectangular opening 36. Sloping face 64 of critical angle prism 38 meets a second face 70 at one edge of the prism and meets a third face 72 at the opposite edge.

In one embodiment of the present invention, illustrated in FIG. 14A, ambient light illuminates a sample fluid deposited on sloping face 64 and enters an optical path inside the refractometer. In this embodiment cover 40 is made of a clear material which is transparent for ambient light entering the optical path through cover 40.

In another embodiment of the present invention, illustrated in FIG. 14B, the light that illuminates a sample fluid 47 on sloping face 64 and enters the optical path is generated by an LED 71 situated under a lower face 73 of critical angle prism 38. The light from LED 71, emitted in all directions, first travels through critical angle prism 38 and through sample fluid 47 until the light reaches a diffuse reflective surface 41 of cover 40. The light from LED 71 is then scattered from diffuse reflective surface 41 in all directions. For example, a plurality of selected parallel beams 43 in FIG. 14B is reflected from diffuse reflective surface 41 back into sample fluid 47, refracts back into critical angle prism 38 at face 64 and exits prism 38 as an array of parallel beams after being refracted once again at a face 75 of prism 38. The light reflected from diffuse reflective surface 41 refracts back into prism 38 at all angles up to the critical angle of refraction. As shown in FIG. 14B, a beam 45 which is incident on face 64 at the critical angle does not enter critical angle prism 38, because it is totally reflected at face 64. All beams which are incident on face 64 at angles greater than the critical angle will not refract back to critical angle prism 38, but will be totally reflected at face 64, therefore, producing a shadowline (not shown) on a reticle. In this embodiment of the present invention it is contemplated that preferably monochromatic LED 71 fits into housing 12 and provides sufficient illumination to form an image on the reticle.

Wedge 58 is mounted inside spaced apart side panels 52 and 54 next to critical angle prism 38, as illustrated in FIGS. 15 and 16A. Major surface 74 of wedge 58 is coated with a reflective coating, thus, transforming major surface 74 into a mirror and transforming wedge 58 into a one-piece mirror-wedge combination.

As shown in FIGS. 15 and 16A, the wedge-mirror combination is attached to a pivoting shaft member 76 that is pivotally supported at both ends by spaced apart side panels 52 and 54. In particular, rod-like extensions at opposite axial ends of shaft member 76 seat in notches 77a and 77b in side walls 52 and 54, respectively. Pivoting shaft member 76 has an upper flattened surface 78 and is allowed to rotate about a longitudinal axis (a). A bimetallic strip 60 is attached at its first end 80 to upper flattened surface 78 of pivoting shaft member 76. Bimetallic strip 60 is suspended or cantilevered parallel to the optical axis (x) of the refractometer. The second end 82 of bimetallic strip 60 is secured to a bimetallic spring means 62 which applies a load through bimetallic strip 60 against a set screw 84. Bimetallic strip 60 and spring

means 62 together with a one-piece wedge-mirror combination constitute the temperature compensation mechanism utilized in the brake fluid refractometer of the present invention. Temperature changes make bimetallic strip 60 bend and, therefore, drive the wedge-mirror combination in a rotational motion about the axis (a) shown in FIG. 15. When bimetallic strip 60 bends, its has to overcome the friction between ends 86 and 88 of pivoting shaft member 76 and spaced apart side panels 52 and 54 of frame 50. Furthermore, the bimetallic strip 60/set screw 84 combination exerts the force on bimetallic strip 60 opposite to the direction in which bimetallic strip 60 bends. Therefore, adjusting set screw 84 up and down allows to calibrate the refractometer.

The calibration procedure of the present invention comprises the following steps. First, using a first calibration fluid with a known water content a user observes a position of the boundary between dark and light areas on the reticle as shown by line A in FIG. 16B. If boundary A falls below the reading corresponding to the known water content (line Z in FIG. 16B), an adjustment is made by rotating screw 84 which, in turn, rotates wedge 58, as can be seen in FIG. 16A. Screw 84 is adjusted until boundary A lies above line Z at a distance  $d=0.5 \times (Z-A)=0.5 \times \Delta d$ . In the case when the initial measurement produces boundary A above line Z, wedge 58 is adjusted by screw 84 so that boundary A moves to a position below line Z at a distance  $d=0.5 \times (A-Z)=0.5 \times \Delta d$ .

The next step of the calibration procedure is to adjust lens 90 by rotating a screw 85 (shown in FIG. 16A) so that boundary A coincides with line Z. Next, using a second calibration fluid the same calibration procedure is repeated. The calibration procedure is repeated until the calibration requirements are met.

After the light passes through a sample fluid deposited on face 64 of critical angle prism 38, one portion of that light gets totally reflected at face 64. The other portion of the light which was not totally reflected then travels through critical angle prism 38, then through wedge 58 and lens 90 to form an image on a reticle 92. As illustrated in FIG. 16C, the image on reticle 92 comprises a dark area 93, corresponding to the totally reflected portion of the light, and a light area 95, corresponding to the light impinging upon reticle 92. Reticle 92 comprises at least one scale 97 with marks corresponding to one or more parameters to be measured, such as, for example, a boiling point or a water content of a hydraulic fluid. A boundary 99 impinges upon reticle 92 at such a mark that corresponds to the measured parameters in a particular hydraulic fluid.

In the refractometer of the present invention it is contemplated that a single apparatus can be used to test different kinds of hydraulic fluids, provided that reticle 92 comprises different scales corresponding to different hydraulic fluids. Such a reticle can be of different shapes and designs. For example, one of the embodiments of the refractometer of the present invention comprises a reticle 120 shaped as a cube or a rectangular prism, as illustrated in FIG. 16D. In this embodiment reticle 120 is rotated in the refractometer by a knob 122. Side faces of reticle 120 comprise scales that correspond to different types of hydraulic fluids. As shown in FIG. 16D, faces 124 and 126 of reticle 120 comprise scales 121 and 123, respectively. A user will see such a face of reticle 120 that coincides with an image plane on which an image is formed. Therefore, the user will be provided with a reading corresponding to a particular type of hydraulic fluid on a scale coinciding with the image plane.

By turning knob 122 a different scale is placed into image plane and, therefore, the same refractometer can be utilized

for measuring a boiling point and a water content of a different brake fluid.

In yet another embodiment of a single refractometer used for testing various hydraulic fluids reticle 92 is disc-shaped, as illustrated in FIGS. 16E and 16F. A number of scales, corresponding to different types of brake fluids, is depicted on the reticle. The reticle can be rotated around axis L by a knob 130. An image area 132 comprises a scale that corresponds to a particular hydraulic fluid and can be viewed by a user. When properties of another brake fluid are measured by the refractometer, reticle 92 is rotated so that the appropriate scale is positioned in image area 132.

In a situation when a refractometer is used only for a certain kind of hydraulic fluid, a user is provided with a kit of several refractometers. Each of the refractometers is manufactured and calibrated for use with a particular hydraulic fluid. The user selects the refractometer corresponding to the type of a fluid that needs be tested.

It is important to emphasize that having temperature compensating means in the form of a one-piece mirror-wedge combination coupled to a bimetallic member provides a novel device for the proper temperature compensation function of the refractometer of the present invention. Coated surface 74 of the wedge-mirror combination increases the angular deviation of the beam of light traveling from the critical angle prism 38 into the wedge 58 in a ratio of 2 to 1. FIGS. 17A and B show diagrammatically wedge 58' having surface 74' provided within reflective coating 94. As illustrated in FIGS. 17A and 17B, when the mirror 58' rotates X degrees, beam 96 deviates 2X degrees from its previous position. If surface 74' of wedge 58 were not coated with a reflective coating and did not work as a mirror, then rotation the wedge by 1 degree would lead to an angular displacement of the beam of only a fraction of 1 degree. Also, a larger angular displacement of the beam solves the problem of stretching a narrower range of brake fluid refractive indices over a larger scale that is normally used in refractometers for coolants, because a larger angular displacement carried over the distance between a focusing lens 90 and reticle 92 provides a larger span of an image on the scale of the reticle.

The same mirror serves as an image inverter in the refractometer. As illustrated in FIG. 18, a portion 4 of a beam 2 that previously was totally reflected on the boundary between the sample fluid and the critical angle prism 38 (the upper dark portion) and a portion 6 of beam 2 that was not totally reflected (the lower light portion) change places after beam 2 is reflected by the mirror 8. The upper dark portion 4 becomes the lower dark portion 4a after reflection, the lower light portion 6 becomes the upper light portion 6a, thus, achieving inversion of the image that a user will see on the reticle scale.

An alternate embodiment of the present invention is illustrated in FIGS. 19A-19D. In this embodiment a pivoting shaft member 100 has a cylindrically shaped central portion 102 and two oppositely spaced ends: a first end 106 and a second end 104. One end 108 of a bimetallic strip 110 is attached to a first end 106 of a pivotal shaft member 100. The other end 112 of bimetallic strip 110 is attached to a spring means 114. In this embodiment when bimetallic strip 110 bends due to a change of temperature, it applies a rotational force on first end 106 of pivoting shaft member 100 which causes rotation of a one-piece wedge-mirror combination 116, therefore, providing temperature compensation in the refractometer.

Other embodiments of the brake fluid refractometer of the present invention comprise a mirror 200 and wedge 58 not

as a one-piece element, but as two separate optical elements, as illustrated in FIGS. 20 and 21. FIG. 21 shows a three-piece prism 38—wedge 58—mirror 200 combination that magnifies the image 10 times, as opposed to a 7 fold magnification in an optical scheme shown in FIG. 20. FIG. 22 depicts the prism 38—wedge 58—mirror 200 combination with a telephoto focusing lens system. The telephoto focusing lens system is used to focus the image at a shorter distance, because the brake fluid refractometer is manufactured to be housed into a housing of a predetermined sized, such as the housing manufactured for coolant refractometers.

It is also contemplated that the refractometer for hydraulic fluids of the present invention is provided together with the instructions on how to operate the refractometer. In particular, a user will be instructed to deposit a sample of the hydraulic fluid that is being tested on a surface of the critical angle prism.

It is appreciated that various modifications to the inventive concepts described herein may be apparent to those of ordinary skill in the art without departing from the spirit and scope of the present invention as defined by the appended claims.

What is claimed is:

1. A refractometric apparatus for use with a hydraulic fluid, comprising:

means for defining an optical path;

an array of photosensitive elements located along the optical path, the array being electrically coupled to a character display;

a prism located along the optical path in spaced relation to the array of photosensitive elements, the prism having a face disposed toward a sample of the hydraulic fluid, the prism being located to receive light for illuminating the sample of the hydraulic fluid, whereby a transition between light and darkness is a function of a water content in the hydraulic fluid;

a reflecting element located along the optical path between the prism and the array of photosensitive elements; and

a temperature sensitive means operatively engaging the reflecting element for pivotal motion of the reflecting element in response to temperature changes so as to compensate for temperature changes by altering the optical path in response to such changes;

whereby the character display provides a reading relating to the water content of the hydraulic fluid.

2. The apparatus of claim 1 further comprising a focusing means for forming an image on the array of photosensitive elements, the focusing means being situated along the optical path between the reflecting element and the array of photosensitive elements.

3. A refractometric apparatus for use with hydraulic fluids, comprising:

means for defining an optical path;

an array of photosensitive elements located along the optical path, the array being electrically coupled to a character display;

a prism located along the optical path in spaced relation to the array of photosensitive elements, the prism having a face disposed toward a sample of the hydraulic fluid, the prism being located to receive light for illuminating the sample of the hydraulic fluid, whereby a transition between light and darkness is a function of a water content in the hydraulic fluid;

## 13

a second prism located along the optical path between the prism and the array of photosensitive elements, the second prism having a face covered by a reflective coating; and

a temperature sensitive means operatively engaged the second prism for pivotal motion of the second prism in response to temperature changes so as to compensate for temperature changes by altering the optical path in response to such changes;

whereby the character display provides a reading relating to the water content of the hydraulic fluid.

4. A refractometric apparatus for use with a hydraulic fluid, comprising:

means for defining an optical path;

an array of photosensitive elements located along the optical path and electrically coupled to a character display;

a prism located along the optical path, the prism having a face disposed toward a sample of the hydraulic fluid, the prism being located to receive light for illuminating the sample of the hydraulic fluid, whereby a transition between light and darkness is a function of water content in the hydraulic fluid;

a reflecting element located along the optical path; and  
a temperature sensitive means for engaging the reflecting element in pivotal motion, wherein the temperature compensation is selected to correspond to a temperature coefficient of a hydraulic fluid within a range of  $-30 \times 10^{-5}/^{\circ}\text{C}$ . to  $-50 \times 10^{-5}/^{\circ}\text{C}$ ;

whereby the character display provides a reading relating to the water content of the hydraulic fluid.

5. A method for measuring water content in a hydraulic fluid for use with an apparatus comprising means for defining an optical path, critical angle prism, the critical angle prism having a face, a temperature compensation means, and an array of photosensitive elements disposed along the optical path and electrically couples to a character display, the method comprising the steps of:

placing the hydraulic fluid on the face of the critical angle prism;

allowing light to enter the optical path through the hydraulic fluid;

compensating for temperature changes by altering the optical path in response to the ambient temperature; and

observing a reading on the character display, the reading being indicative of a water content of the hydraulic fluid.

6. In a method of measuring water content in a hydraulic fluid for use with an apparatus comprising means for defining an optical path, a critical angle prism, the critical angle prism having a face, a temperature compensation means, and an array of photosensitive elements electrically coupled to a character display and disposed along the optical path, a calibration method comprising the steps of:

placing the hydraulic fluid on the face of the critical angle prism, the hydraulic fluid being of a known water content;

allowing light to pass through the hydraulic fluid and to enter the optical path; and

adjusting the optical path so that a boundary between light and darkness impinges upon the array of photosensitive element at a predetermined point, producing a predetermined reading on the character display.

## 14

7. The apparatus of claim 1, wherein the temperature sensitive means comprises a bimetallic member and wherein the reflecting element comprises a wedge located along the optical path between the prism and the array of photosensitive elements, the wedge being mounted for pivotal motion.

8. The apparatus of claim 7, wherein the wedge comprises a face with a reflective coating, the face comprising the reflecting element.

9. The apparatus of claim 1, wherein the face of the prism disposed toward the sample of the hydraulic fluid is also disposed toward ambient light.

10. The apparatus of claim 1 further including a light source and wherein the prism has another face disposed toward the light source.

11. The apparatus of claim 2, wherein the focusing means further comprises an objective lens.

12. The apparatus of claim 1, wherein the reflective element comprises a mirror disposed along the optical path between the prism and the temperature sensitive means.

13. The apparatus of claim 3, further comprising a focusing means for forming an image on the array of photosensitive elements, the focusing means being situated along the optical path between the reflecting element and the array of photosensitive elements.

14. The apparatus of claim 13, further comprising a frame, wherein the prism and the array of photosensitive elements are mechanically couples to the frame.

15. The apparatus of claim 13, wherein the focusing means further comprises an objective lens.

16. The apparatus of claim 3, wherein the temperature sensitive means is pivotally coupled to the frame and further mechanically coupled to the second prism, the temperature sensitive means further comprising a bimetallic strip and bimetallic spring.

17. The method of claim 5, wherein placing the hydraulic fluid comprises placing the brake fluid.

18. The method of claim 5, wherein compensating for temperature changes is selected to correspond to a refractive index of hydraulic fluid within the range of  $-30 \times 10^{-5}/^{\circ}\text{C}$ . to  $-50 \times 10^{-5}/^{\circ}\text{C}$ .

19. The method of claim 6, wherein the known water content of the hydraulic fluid comprises being substantially free of water.

20. The method of claim 6, wherein the hydraulic fluid if a brake fluid.

21. The method of claim 19, wherein the hydraulic fluid is a brake fluid.

22. A method of measuring water content in a hydraulic fluid for use with a plurality of apparatus, each apparatus comprising means for defining an optical path, a critical angle prism, the critical angle prism having a face, a temperature compensation means comprising a reflecting element and a temperature sensitive element operatively engaging the reflecting element for pivotal motion, and an array of photosensitive elements electrically coupled to a character display disposed along the optical path, the method comprising:

selecting an apparatus according the the hydraulic fluid to be analyzed;

placing a sample of the hydraulic fluid on the face of the critical angle prism, the hydraulic fluid being of a known water content;

allowing light to pass through the hydraulic fluid and to enter the optical path; and

observing a reading on the character display, the reading being indicative of the water content in the hydraulic fluid.

## 15

23. The method of claim 22, wherein placing the sample of the hydraulic fluid comprises placing the sample of a brake fluid.

24. The method of claim 22, further comprising compensating for temperature changes by altering the optical path in response to the ambient temperature. 5

25. The method of claim 24, wherein compensation for temperature changes is selected to correspond to a refractive index of a hydraulic fluid within the range of 1.4 to 1.5.

26. The method of claim 24, wherein compensating for temperature changes is selected to correspond to a refractive index of a hydraulic fluid within the range of  $-30 \times 10^{-5}/^{\circ}\text{C}$ . to  $-50 \times 10^{-5}/^{\circ}\text{C}$ . 10

27. A method of measuring a water content in a plurality of types of hydraulic fluids for use with an apparatus, the apparatus comprising means for defining an optical path, a critical angle prism, the critical angle prism having a face, an array of photosensitive elements disposed along the optical path and electrically coupled to a character display, a temperature sensitive means disposed along the optical path, and an adjustment means for selecting a type of a hydraulic fluid, the method comprising: 15

adjusting the adjustment means to correspond to the type of the hydraulic fluid;

placing the hydraulic fluid on the face of the critical angle prism; 25

allowing light to enter the optical path through the hydraulic fluid;

compensating for temperature changes by altering the optical path in response to the ambient temperature; and 30

observing a reading on the character display, the reading being indicative of a water content of the hydraulic fluid. 35

28. The method of claim 27, wherein the hydraulic fluid is a brake fluid.

29. The method of claim 28, further comprising removing the sample of the brake fluid from a brake system, performed prior to the placing. 40

30. The method of claim 28, further comprising a final step of discarding the brake fluid from the brake system if the boundary between light and darkness is within a predetermined region of the array of photosensitive elements.

31. The method of claim 28, wherein the light entering the optical path through the hydraulic fluid is generated by an LED. 45

32. The method of claim 27, wherein compensating for temperature changes is selected to correspond to a refractive index of a hydraulic fluid within a range of 1.4 to 1.5. 50

33. The method of claim 27, wherein compensating for temperature changes is selected to correspond to a temperature coefficient of a hydraulic fluid within a range of  $-30 \times 10^{-5}/^{\circ}\text{C}$ . to  $-50 \times 10^{-5}/^{\circ}\text{C}$ .

## 16

34. A refractometric apparatus for use with a hydraulic fluid, comprising:

means for defining an optical path;

an array of photosensitive elements located along the optical path, the array being electrically coupled to a character display;

a prism located along the optical path in spaced relation to the array of photosensitive elements, the prism having a face disposed toward a sample of the hydraulic fluid, the prism being located to receive light for illuminating the sample of the hydraulic fluid, whereby a transition between light and darkness is a function of a water content in the hydraulic fluid;

a reflecting element located along the optical path between the prism and the array of photosensitive elements;

a temperature sensitive means operatively engaging the reflecting element for pivotal motion of the reflecting element in response to temperature changes so as to compensate for temperature changes by altering the optical path in response to such changes; and

an adjusting means for altering the optical path to correspond to each of a plurality of types of the hydraulic fluids;

whereby the character display provides a reading relating to the water content of the hydraulic fluid.

35. The apparatus of claim 34, wherein the hydraulic fluid is a brake fluid.

36. The apparatus of claim 34, further comprising a focusing means for forming an image on the reticle, the focusing means being disposed along the optical path element the reflecting member and the array of photosensitive elements. 35

37. The apparatus of claim 34, wherein the temperature sensitive element further comprises a wedge disposed along the optical path between the first prism and the array of photosensitive elements, the wedge comprising the reflecting element, the wedge being rotatably couple to the frame and further mechanically coupled to a bimetallic member. 40

38. The apparatus of claim 37, wherein the wedge comprises a face with a reflective coating, the face comprising the reflecting element.

39. The apparatus of claim 34, wherein a face of the first prism toward an LED defines the second face.

40. The apparatus of claim 36, wherein the focusing means further comprises an objective lens.

41. The apparatus of claim 34, wherein the reflecting element comprises a mirror disposed along the optical path between the first prism and the temperature sensitive means.

\* \* \* \* \*